

Specification Sheet for Product:

Signature Hardware 478941

**Teak / Arctic White Novak 48" Freestanding Teak Single Basin
Vanity Set with Cabinet, Vanity Top, and Rectangular Undermount
Sink - Single Faucet Hole**

48" NOVAK TEAK VANITY WITH RECTANGULAR UNDERMOUNT SINK - TEAK

SKU: 953363-48-RUMB

Code: SH480906, SH478938, SH478940, SH478935, SH478936, SH478943, SH478937, SH478941, SH478939, SH478934



FEATURES

Material: Teak
Product Finish: Teak
Number of Doors: 2
Number of Drawers: 7
Dovetail Drawers: Yes
Hardware Finish: Brass
Built-In Adjusters: Yes

LISTED ID: 506897



ADDITIONAL FEATURES

- Each stone top is carved from a single piece of stone and will feature natural variations.
- Teak top is kiln dried and sanded to a smooth finish.
- Teak top has a monocoat oil finish. Monocoat is a plant-based, non-toxic, environmentally friendly wood finish that protects and restores with one coat. Use monocoat cleaning agents only to care for and maintain this finish.
- 2" diameter cutout for sink.
- We will drill your faucet hole to fit the sink on your order. If no sink is ordered, we will drill the faucet hole to fit a standard 16-1/2" sink.
- See Installation Instructions for directions to attach the vanity top and sink.
- [Wood finish samples available.](#)

REVISED 8/12/2024

48" NOVAK TEAK VANITY WITH RECTANGULAR UNDERMOUNT SINK - TEAK

SKU: 953363-48-RUMB

Code: SH480906, SH478938, SH478940, SH478935, SH478936, SH478943, SH478937, SH478941, SH478939, SH478934

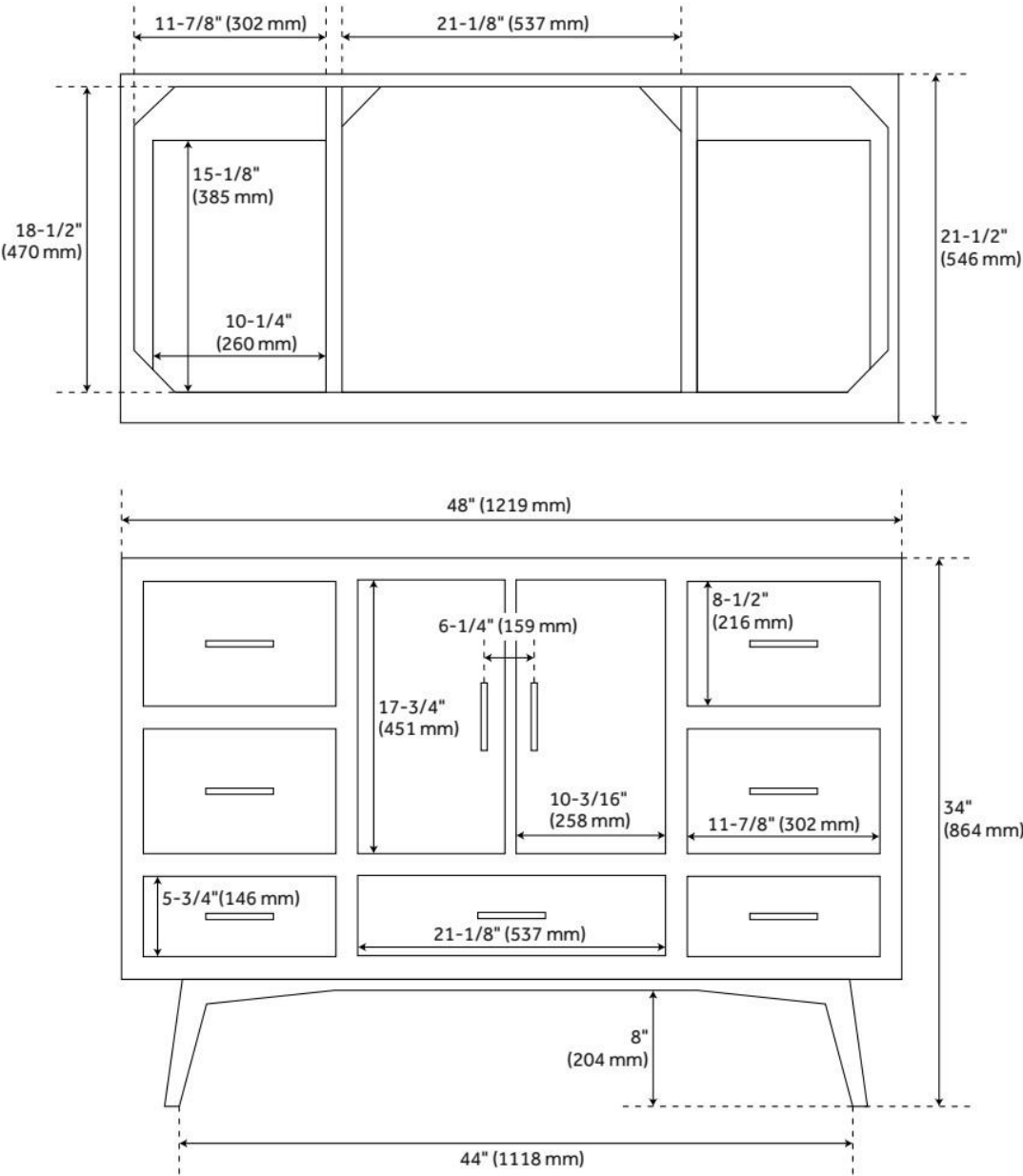

REVISED 8/12/2024

Specification Sheet for Product:

Delta 548LF-SSMPU

**Brilliance Stainless Bowery 1.2 GPM Single Hole Bathroom Faucet
with Push Button Drain Assembly - Limited Lifetime Warranty**

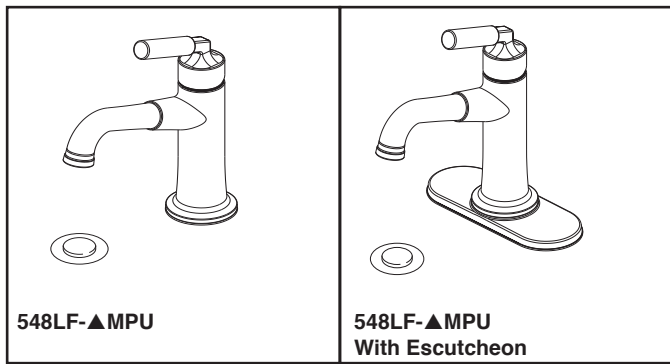

see what Delta can do™

BATHROOM FAUCET

- Bowery™ Collection
- Single Handle Deck Mount

STANDARD SPECIFICATIONS:

- Max. flow rate 1.2 gpm @ 60 psi, 4.5 L/min @ 414 kPa
- Order aerator RP101953-1.0 for maximum 1.0 gpm @ 60 psi, 3.8 L/min @ 414 kPa
- Order aerator RP101953-0.5 for maximum 0.5 gpm @ 60 psi, 1.9 L/min @ 414 kPa
- Solid metal construction
- One or three hole mount (escutcheon optional, included)
- 1/4" O.D. straight, staggered PEX supply tubes
- Diamond coated ceramic cartridge
- Handle motion "Euro Style"
- Optional red/blue indicator ring provided with model
- Models have metal drain with push pop-up type fitting with plated flange and stopper, no lift rod hole

WARRANTY

- Parts and Finish - Lifetime limited warranty; or for commercial purchasers, 10 years for multi-family residential (apartments and condominiums) and 5 years for all other commercial uses, in each case from the date the product is received by the original purchaser or their authorized representative (installation contractor, etc.).
- Electronic Parts and Batteries (if applicable) - 5 years from the date the product is received by the original purchaser or their authorized representative (installation contractor, etc.); or for commercial purchasers, 1 year from the date the product is received by the original purchaser or their authorized representative (installation contractor, etc.). No warranty is provided on batteries.



COMPLIES WITH:

- ASME A112.18.1 / CSA B125.1
- ASME A112.18.2 / CSA B125.2
- Indicates compliance to ICC / ANSI A117.1
- EPA WaterSense® - 1.2 GPM models only

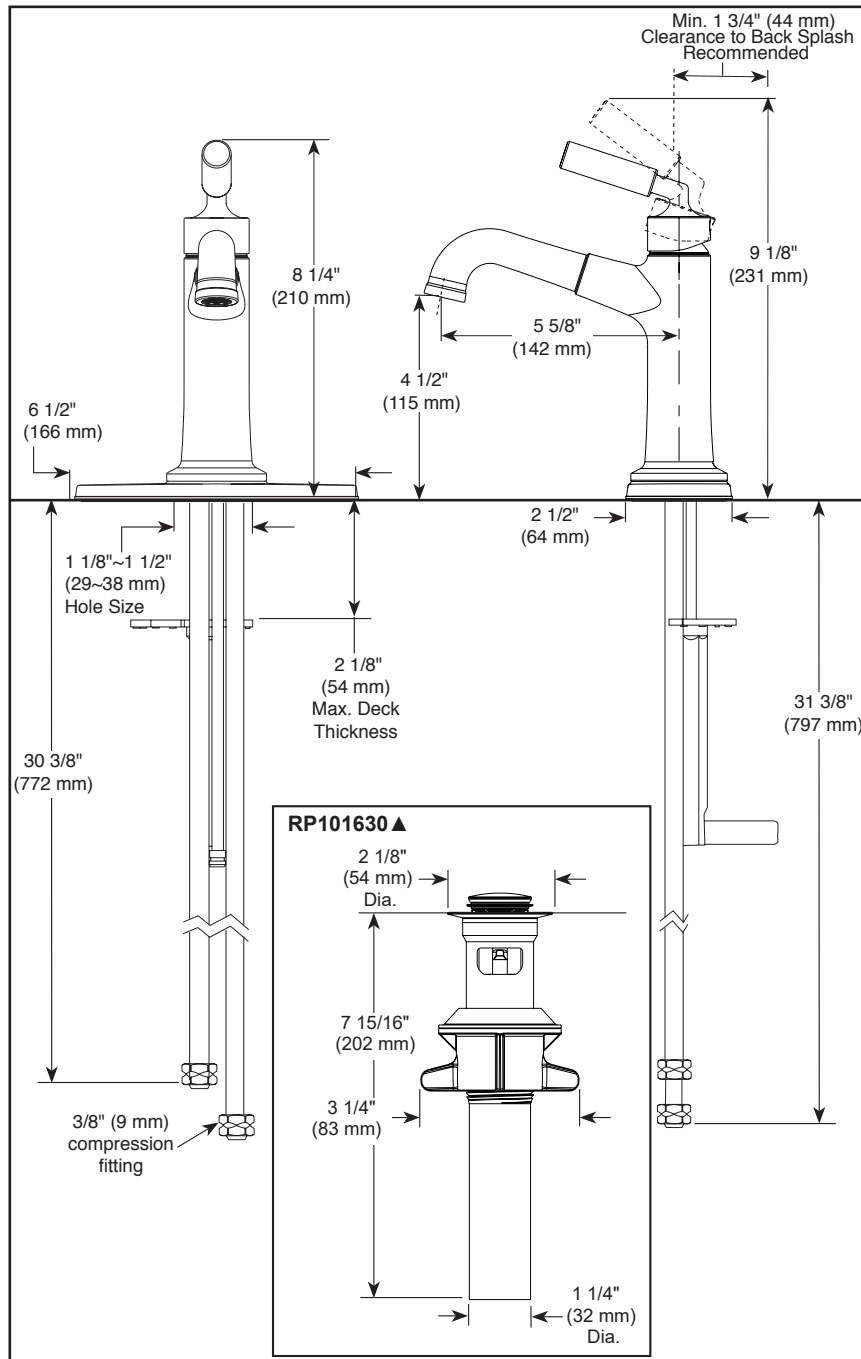

▲ Designate proper finish suffix

Delta reserves the right (1) to make changes in specifications and materials, and (2) to change or discontinue models, both without notice or obligation. Dimensions are for reference only. See current full-line price book or www.deltafaucet.com for finish options and product availability.

DSP-L-548LF-MPU Rev. C

Delta Faucet Company

55 E. 111th Street, Indianapolis, IN 46280
350 South Edgeware Road, St. Thomas, ON N5P 4L1
© 2023 Delta Faucet Company

Specification Sheet for Product:

Delta T14048-SS

**Brilliance Stainless Bowery Monitor 14 Series Single Function
Pressure Balanced Shower Trim - Less Rough-In Valve**

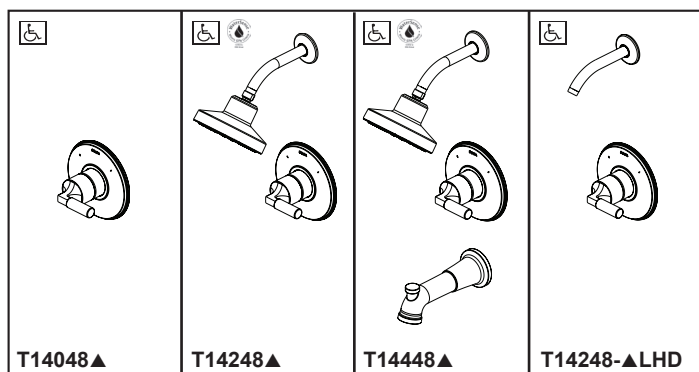

Submitted Model No.: _____

Specific Features: _____

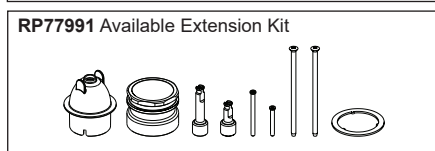
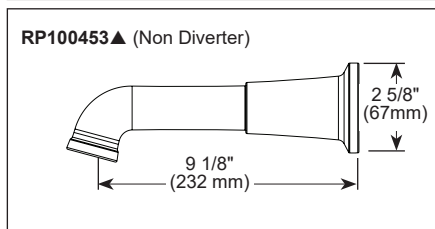
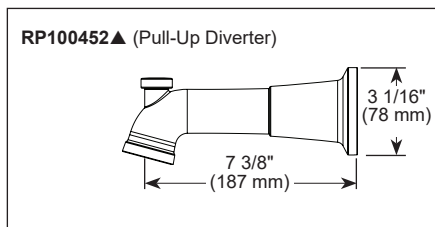
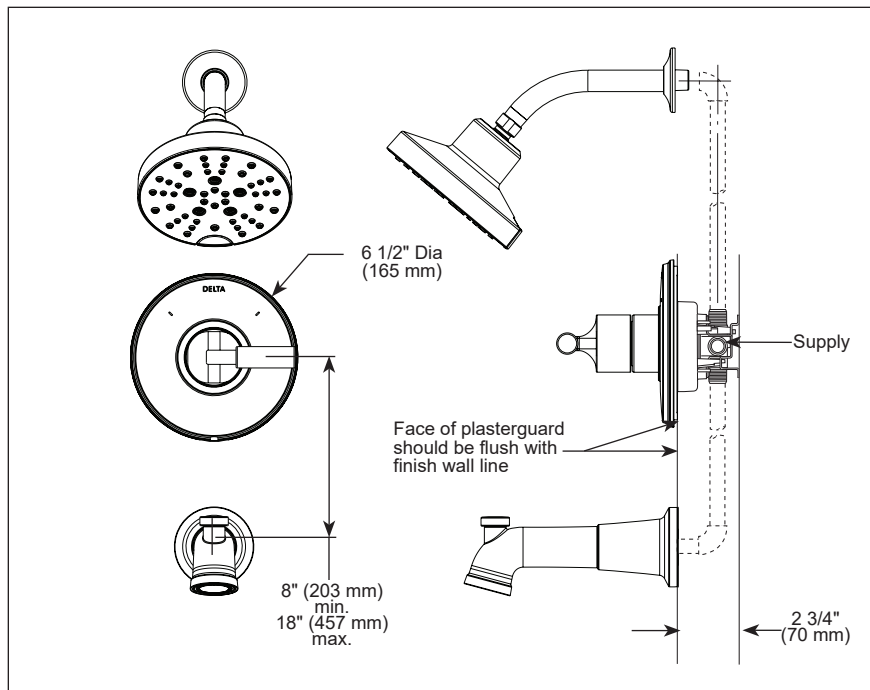

52668 ▲ 1.75 GPM H₂O Showerhead



Full Body Spray



H2Ok kinetic Spray



Pause



Full Spray w/Massage



Massage Spray

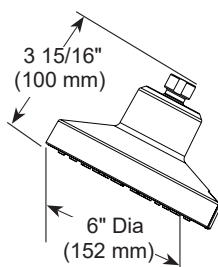

see what Delta can doSM TUB AND SHOWER FAUCET TRIM

- Bowery™ Bath Collection
- Valve Only (T14048)
- Shower Only (T14248)
- Tub/Shower (T14448)

FEATURES:

- Monitor® 14 Series pressure balanced bath single handle mixing valve trim
- Five-setting H₂Ok kinetic® Technology showerhead

STANDARD SPECIFICATIONS:

- Maintains a balanced pressure of hot and cold water even when a valve is turned on or off elsewhere in the system.
- For use with MultiChoice® Universal rough valve body. (R10000 Series)
- Back-to-back installation capability.
- Temperature only controlled with handle.
- Field adjustable to limit handle rotation into hot water zone.
- 120° maximum handle rotation.
- All parts replaceable from the front of the valve.
- Maximum 1.75 gpm @ 80 psi, 7.60 L/min @ 550 kPa.
- Tub port max flow rate 6.0 gpm at 60 psi with R10000-UNBX
- Red/blue pad print temperature indicator on the shower escutcheon.
- "LHD" models indicate less showerhead.
- Stem extension kit RP77991 can be ordered to allow for an additional 1 3/4" wall thickness.
- Shower arm overall horizontal length = 7" (178mm), including threaded ends

WARRANTY

- Parts and Finish – Lifetime limited warranty; or for commercial purchasers, 10 years for multi-family residential (apartments and condominiums) and 5 years for all other commercial uses, in each case from the date of purchase.
- Electronic Parts and Batteries (if applicable) – 5 years from the date of purchase; or for commercial purchasers, 1 year from the date of purchase. No warranty is provided on batteries.

COMPLIES WITH:

- ASME A112.18.1 / CSA B125.1
- ☑ Indicates compliance to ICC/ANSI A117.1-Valve control only.
- EPA WaterSense®

▲ Designate Proper Finish Suffix

Delta reserves the right (1) to make changes in specifications and materials, and (2) to change or discontinue models, both without notice or obligation. Dimensions are for reference only. See current full-line price book or www.deltafaucet.com for finish options and product availability.

DSP-B-T14048 Rev. A

Delta Faucet Company

55 E. 111th Street, Indianapolis, Indiana 46280
350 South Edgeware Road, St. Thomas, ON N5P 4L1
© 2018 Delta Faucet Company

Specification Sheet for Product:

Delta 58472-SS-PR

**Lumicoat Stainless Universal Showering Round 2.5 GPM Multi
Function 2-in1 In2ition Shower Head and Hand Shower with
H2Okinetic and MagnaTite Technology**

Submitted Model No.: _____

Specific Features: _____



see what Delta can do™

IN2ITION®

- H₂Okinetic® 2-In-1 Shower
- 4-Spray Settings Hand Shower

FEATURES:

- Push Button Selection
- MagnaTite® Docking
- H₂Okinetic® PowerDrench Spray
- Lumicoat™ Finish (-PR models only)
- Lumicoat™ Finishes easily wipe clean without cleaners and chemicals on the products most commonly touched areas

STANDARD SPECIFICATIONS:

- Max. flow rate 2.5 gpm @ 80 psi, 9.5 L/min @ 550 kPa
- Integrated hand shower docks securely into shower head when not in use
- 4 hand shower spray settings - pause is a non-positive shut-off
- 3-Way diverter for single or shared operation of the shower head and hand shower
- Fixed shower head and hand shower all in one
- Change spray modes with push button
- 60" (1524 mm) stretchable metal hose, stretches to 82" (2083 mm) for extra reach
- Lumicoat™ is not applied to the shower hose

WARRANTY

- Parts and Finish - Lifetime limited warranty; or for commercial purchasers, 10 years for multi-family residential (apartments and condominiums) and 5 years for all other commercial uses, in each case from the date of purchase.
- Electronic Parts and Batteries (if applicable) - 5 years from the date of purchase; or for commercial purchasers, 1 year from the date of purchase. No warranty is provided on batteries.

COMPLIES WITH:

- ASME A112.18.1 / CSA B125.1
- ASME A112.18.3

◆ Your Delta Faucet handshower incorporates a backflow protection system that has been tested to be in compliance with ASME A112.18.3 and ASME A112.18.1/CSA B125.1. It incorporates two certified check valves in series, which operate independently and are integral, nonserviceable parts of the wand assembly.

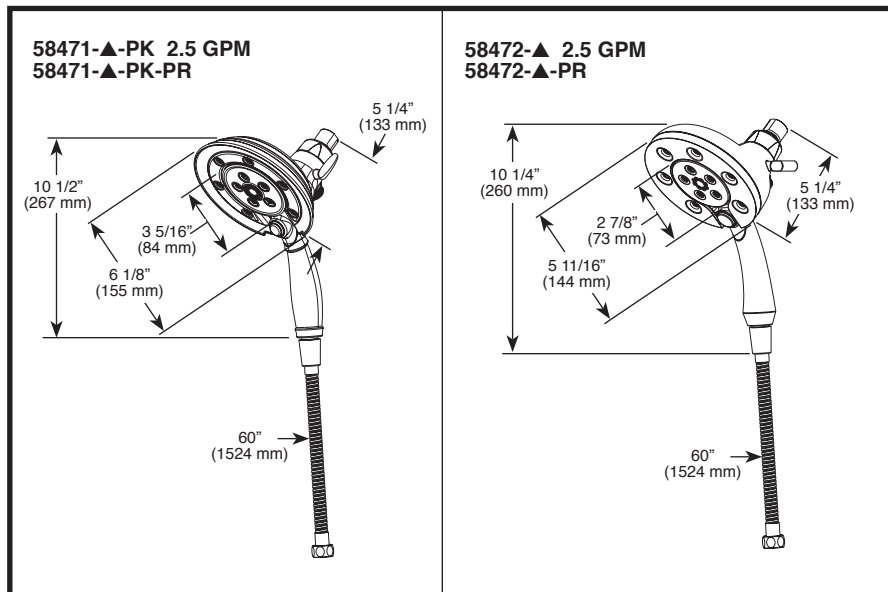

▲ Designate proper finish suffix

Specification Sheet for Product:
Ebbe America E4024
N/A PVC Clamp Collar Drain Bundle

E4022/E4024 DRAIN KIT



MEETS: IAPMO IGC 195-2013a &
ASME A112.18.2 /CSA B125.2
STANDARDS

THE INFORMATION CONTAINED IN THIS DRAWING IS
THE SOLE PROPERTY OF EBBE AMERICA LC.. ANY
REPRODUCTION IN PART OR AS A WHOLE WITHOUT
THE WRITTEN PERMISSION OF EBBE AMERICA IS
PROHIBITED. ebbe-america.com/patent

E4022-ABS E4024-PVC Drain Assembly

Component	QTY	Material
Drain Body	1	ABS or PVC
Clamping Ring	1	ABS or PVC
1/4-20 Bolt	4	Stainless
Riser Body	1	ABS
Construction Debris Plug	1	ABS
Hair trap	1	PP

NOTE: Not For Use In Hot Mop Applications

Total Assembled Weight .75 lbs

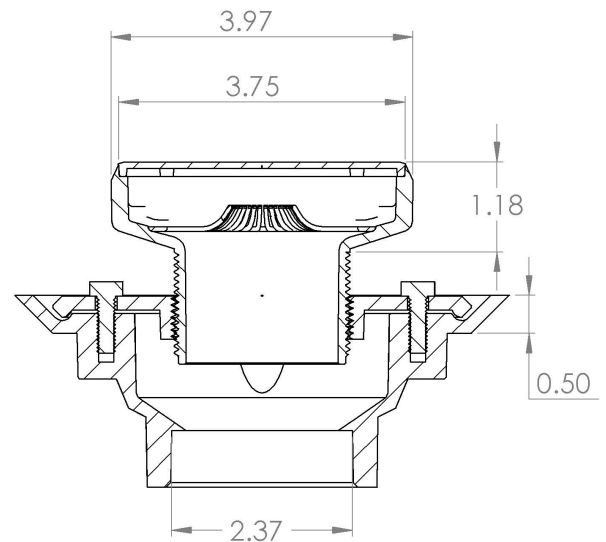
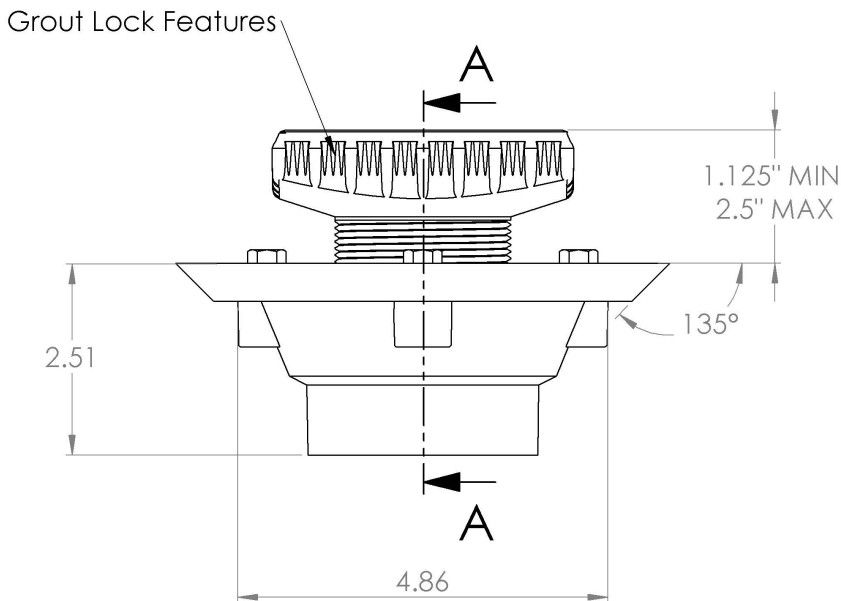
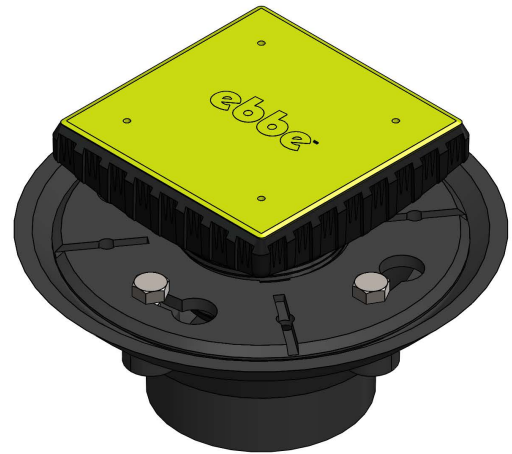
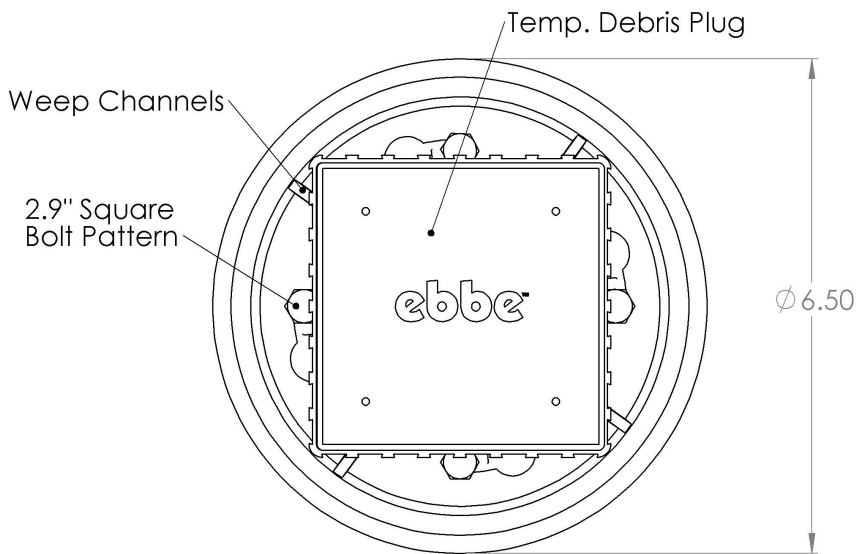

SECTION A-A

Specification Sheet for Product:
Ebbe America E4404
Brushed Nickel PRO Drain Cover - Brushed Nickel

E4401 - E4410

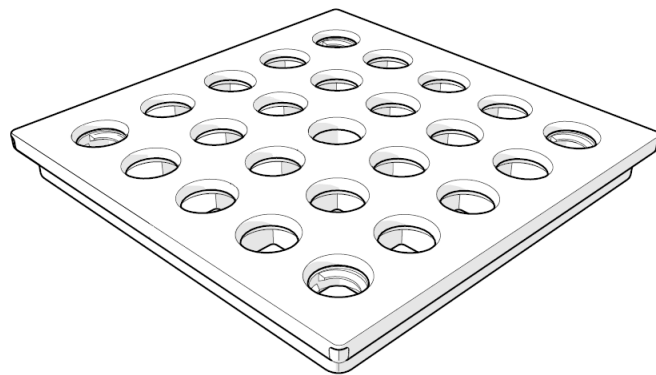
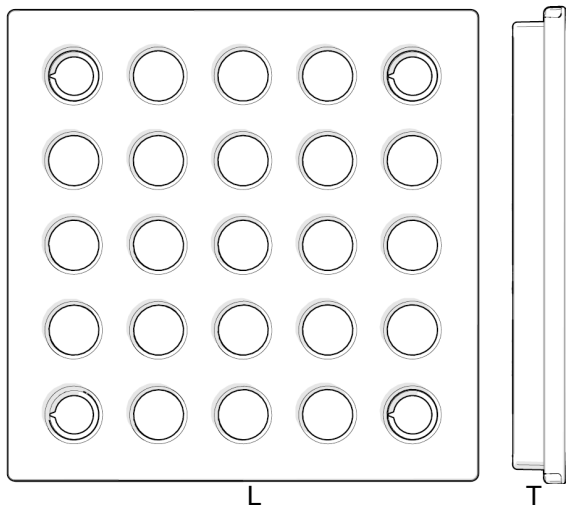

ebbe
PRO

Length (L)	3.75 in
Thickness (T)	0.43 in
Total Open Area	3.16 in ²
GPM	11
Material	Stainless Clad/Polycarbonate
Weight	2.50 oz

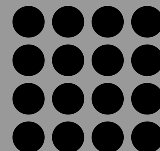

Specification Sheet for Product:

TOTO MS646234CEMFGN#01

**Cotton Aquia IV 0.9 / 1.28 GPF Dual Flush One Piece Elongated
Toilet with Push Button Flush - Seat Included**

Aquia® IV One-Piece Toilet - 1.28 & 0.9 GPF

FEATURES

- DYNAMAX TORNADO FLUSH® utilizes 360° cleaning power to reach every part of the bowl
- Ultra high-efficiency dual flush 1.28 & 0.9 GPF (4.8 & 3.4 LPF)
- CEFIONTECT® ceramic glaze minimizes waste from sticking to porous ceramic surfaces
- Completely skirted design for a sleek and understated look that's easier to clean
- Specially designed to accommodate a WASHLET®+
- Elongated front bowl toilet and seat set
- UNIVERSAL HEIGHT
- Chrome push-button
- 12" Rough-in

MODELS

- **MS646234CEMFGN (#01)**
With CEFIONTECT ceramic glaze & includes SS234 SoftClose® seat

OPTIONAL COMPONENTS

- **SS124**
SoftClose® Seat
- **TSU48.10**
10" Unifit Rough-In
- **TSU48.14**
14" Unifit Rough-In
- **THU848#01-A**
Push Button Assembly - Cotton
- **THU848#PN-A**
Push Button Assembly - Polished Nickel
- **THU848#BN-A**
Push Button Assembly - Brushed Nickel

COLORS/FINISHES

- #01 Cotton



**DYNAMAX
TORNADO FLUSH**



U UNIVERSAL HEIGHT



CEFIONTECT

PRODUCT SPECIFICATION

The one-piece, ultra high-efficiency, DYNAMAX TORNADO FLUSH toilet shall be dual flush 1.28 GPF/0.9 GPF. Toilet shall be coated with CEFIONTECT, elongated front bowl, high profile tank, UNIVERSAL HEIGHT, complete skirted bowl and chrome push-button.

Toilet shall be TOTO Model MS646234CEMFGN#01.

CODES/STANDARDS

- Meets and exceeds ASME A112.19.2/CSA B45.1, ASME A112.19.14
- Certifications: IAPMO(cUPC®), EPA WaterSense, State of Massachusetts and others
- Code Compliance: UPC, IPC, NSPC, NPC Canada, and others
- Legislative Compliance: California Green Building Code, City of Los Angeles Water Efficiency Ordinance, and others
- Complies with CA Prop 65 warning requirements



EPA 9001-2015

MS646234CEMFGN

Aquia® IV One-Piece Toilet - 1.28 & 0.9 GPF

SPECIFICATIONS

Water Use	1.28 & 0.9 GPF (4.8 & 3.4 LPF)
Flush System	DYNAMAX TORNADO FLUSH®
Min. Water Pressure	8 psi (Flowing)
Water Surface	7" x 5"
Trap Diameter	2-1/4"
Rough-in	12" (10" and 14" options available)
Trap Seal	2-1/8"
Warranty	One Year Limited Warranty
Material	Vitreous China
Shipping Weight	118 lbs.
Shipping Dimensions	29-1/2" L x 17-5/8" W x 28-1/8" H

INSTALLATION NOTES

Back-to-Back Toilet Installations:

TOTO recommends the use of a nationally listed, double sanitary tee-wye only, in vertical waste stacks, in accordance with the stipulations noted in the majority of nationally recognized plumbing codes.

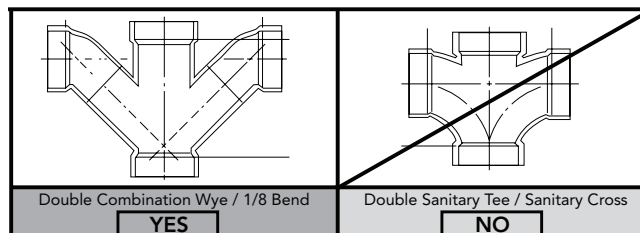

To maintain adequate wall gap between the back of the tank and wall, mount the floor flange at a nominal 12" rough-in distance.

DIMENSIONS

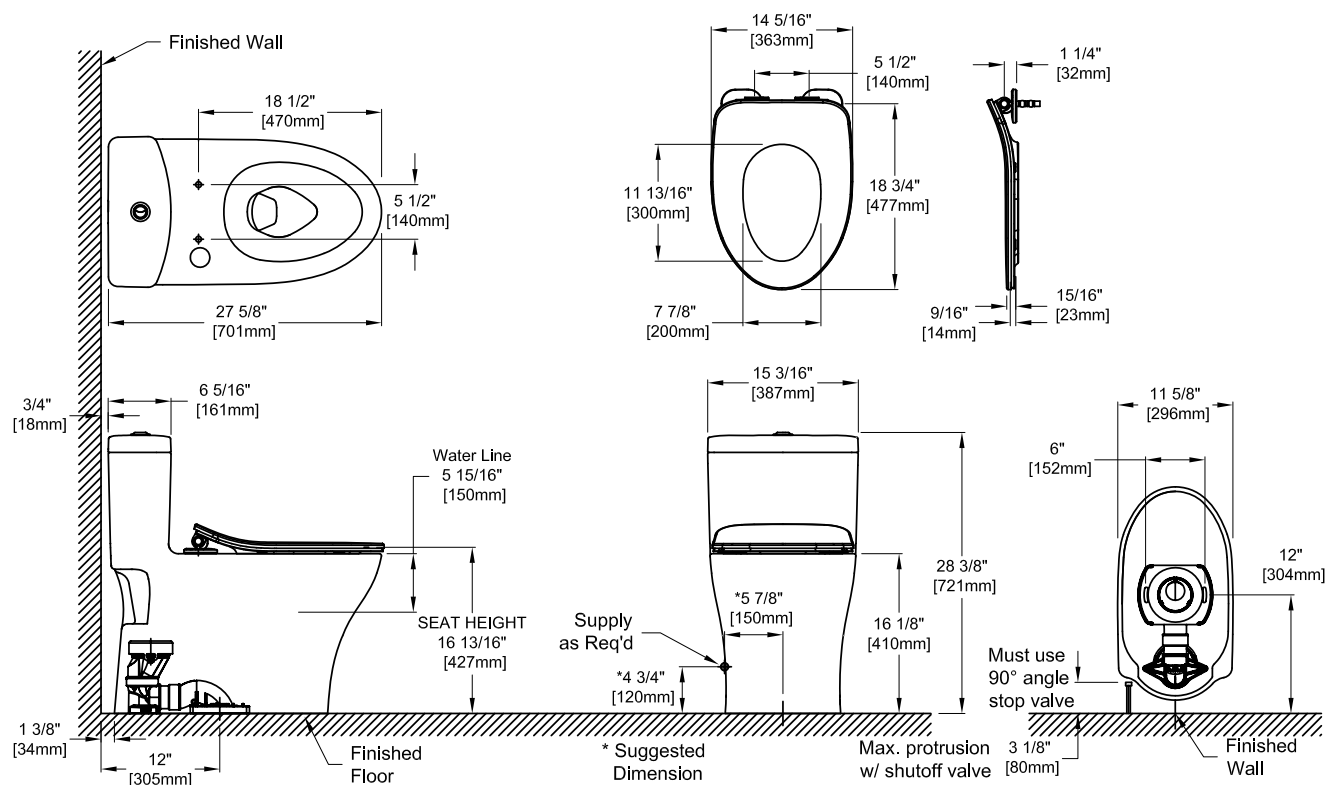

TOTO®

These dimensions and specifications are subject to change without notice

Specification Sheet for Product:

Delta 74855-SS

**Brilliance Stainless Bowery Wall Mounted Pivoting Toilet Paper
Holder - Limited Lifetime Warranty**



see what Delta can do™

ACCESSORIES

- Bowery™ Collection
- Tissue Holder

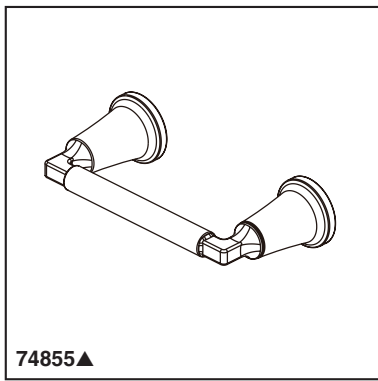

Submitted Model No.: _____

Specific Features: _____

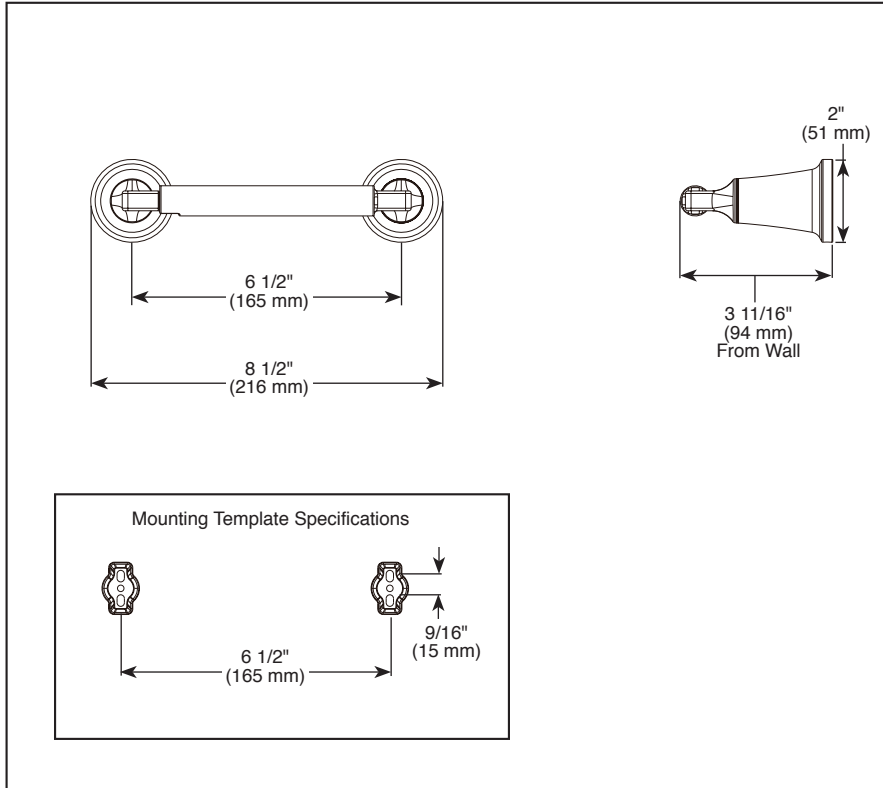

▲ Designate Proper Finish Suffix

STANDARD SPECIFICATIONS:

- Wood blocking is preferable behind all wall surfaces. If wood blocking is not available, the following fasteners are suggested: Tile/Masonry-plastic or lead anchors plaster/drywall-Toggle bolts.
- Mounting hardware included with product.
- Pivoting arm.

WARRANTY

- Parts and Finish – Lifetime limited warranty; or for commercial purchasers, 10 years for multi-family residential (apartments and condominiums) and 5 years for all other commercial uses, in each case from the date of purchase.
- Electronic Parts and Batteries (if applicable) – 5 years from the date of purchase; or for commercial purchasers, 1 year from the date of purchase. No warranty is provided on batteries.

Specification Sheet for Product:
Delta 74835-SS
Brilliance Stainless Bowery Single Robe Hook



see what Delta can do™

ACCESSORIES

- Bowery™ Collection
- Robe Hook

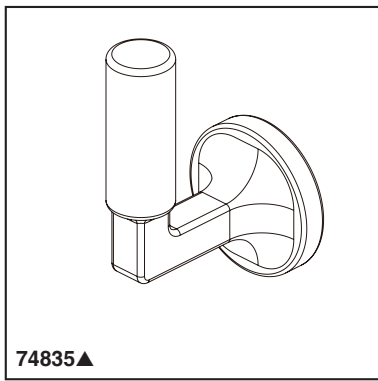

74835▲

Submitted Model No.: _____

Specific Features: _____

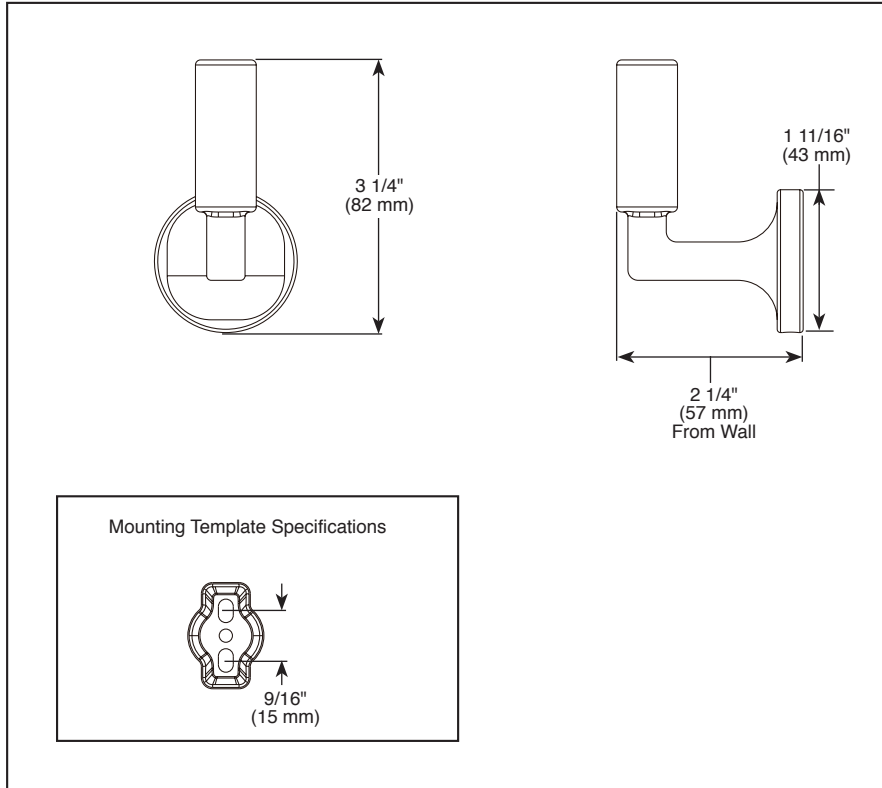

▲ Designate Proper Finish Suffix

STANDARD SPECIFICATIONS:

- Wood blocking is preferable behind all wall surfaces. If wood blocking is not available, the following fasteners are suggested: Tile/Masonry-plastic or lead anchors plaster/drywall-Toggle bolts.
- Mounting hardware included with product.

WARRANTY

- Parts and Finish – Lifetime limited warranty; or for commercial purchasers, 10 years for multi-family residential (apartments and condominiums) and 5 years for all other commercial uses, in each case from the date of purchase.
- Electronic Parts and Batteries (if applicable) – 5 years from the date of purchase; or for commercial purchasers, 1 year from the date of purchase. No warranty is provided on batteries.

Specification Sheet for Product:

Delta 74808-SS

**Brilliance Stainless Bowery 8" Towel Bar - Limited Lifetime
Warranty**



see what Delta can do™

ACCESSORIES

■ Bowery™ Collection

■ 8" Towel Bar

■ 18" Towel Bar

■ 24" Towel Bar

■ 30" Towel Bar

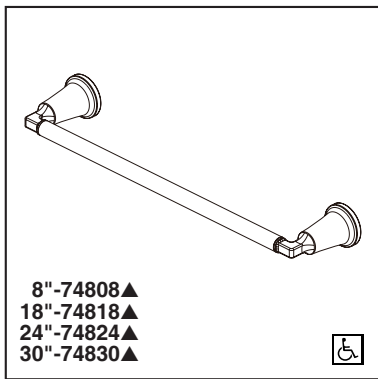

Submitted Model No.: _____

Specific Features: _____

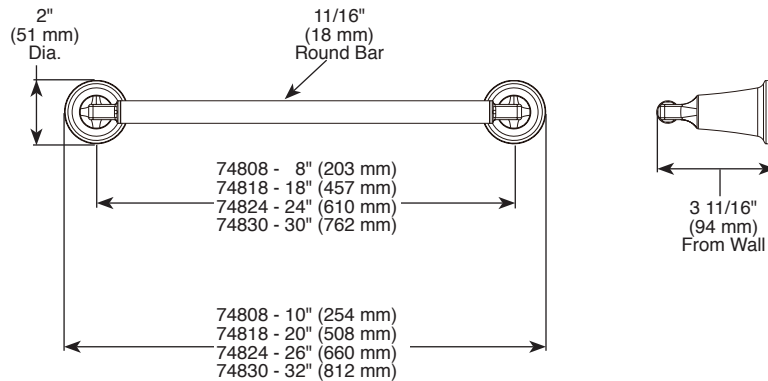

Mounting Template Specifications

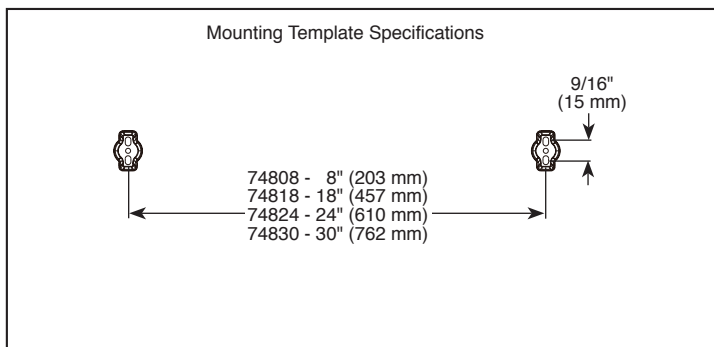

▲ Designate Proper Finish Suffix

Delta Faucet Company

55 E. 111th Street, Indianapolis, Indiana 46280
350 South Edgeware Road, St. Thomas, Ontario Canada N5P 4L1
© 2018 Delta Faucet Company

Delta reserves the right (1) to make changes in specifications and materials, and (2) to change or discontinue models, both without notice or obligation. Dimensions are for reference only. See current full-line price book or www.deltafaucet.com for finish options and product availability.

DSP-A-74808 Rev. A

Specification Sheet for Product:

Delta R10000-UNBX

**N/A Universal Mixing Rough-In Valve with 1/2" NPT Male thread
with 1/2" C.W.T Female Sweat - Box Model**

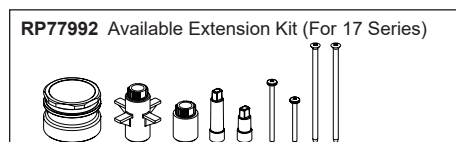
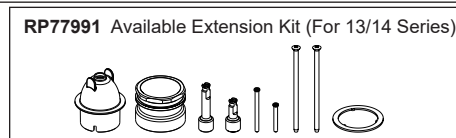
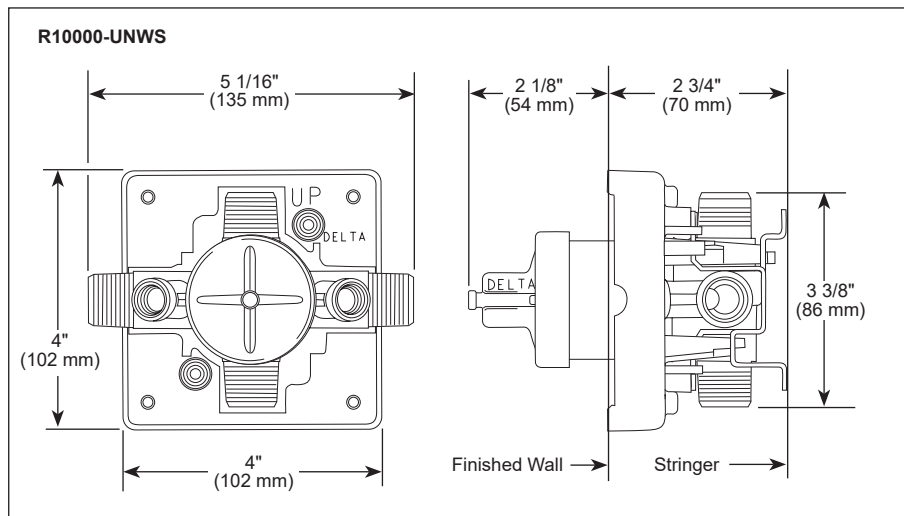
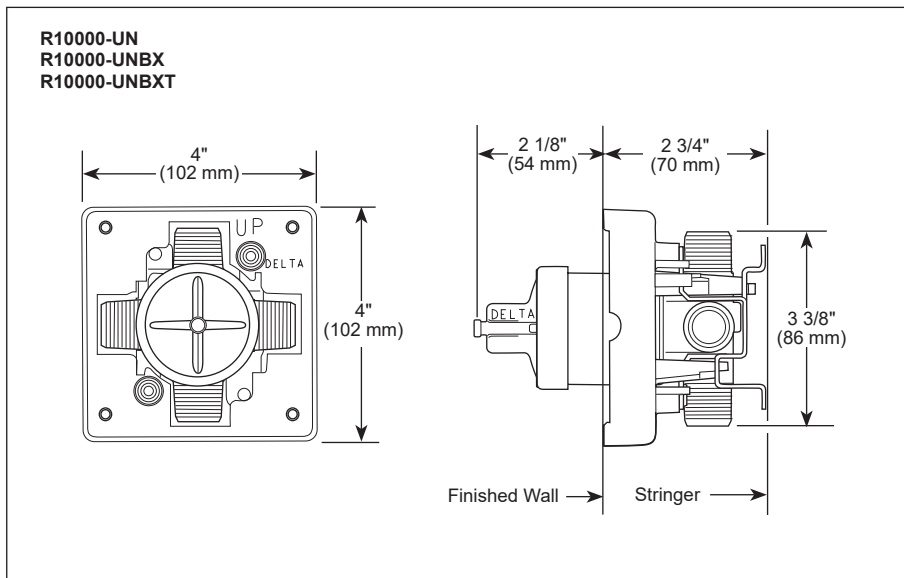
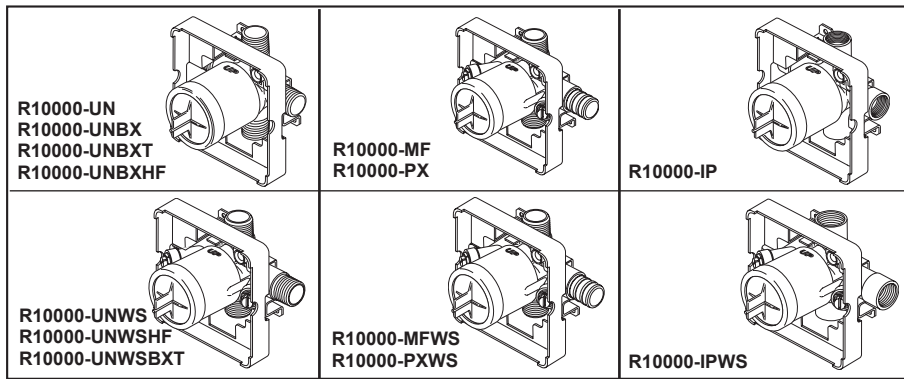

see what Delta can do™ **MULTICHOICE®** **UNIVERSAL ROUGH** **VALVE BODY**

- R10000-UN (Universal Inlets/Outlets)
- R10000-UNBX (Universal Single Box Model)
- R10000-UNBXHF (High Flow Shower Only)
- R10000-UNBXT (Thin Wall)
- R10000-UNWS (Universal with Stops)
- R10000-UNWSHF (High Flow with Stops)
- R10000-UNWSBXT (Thin Wall with Stops)
- R10000-PX (Pex Crimp Connections with UN Outlets)
- R10000-PXWS (Pex Crimp Connections with Stop with UN Outlets)
- R10000-IP (IPS Inlets/Outlets)
- R10000-IPWS (IPS with Stops)
- R10000-MF (Pex Cold Expansion Connections with UN Outlets)
- R10000-MFWS (Pex Cold Expansion with Stops with UN Outlets)

STANDARD SPECIFICATIONS:

- Forged brass body.
- Back-to-Back installation capabilities.
- Can be tested with air (200 PSI) or water (300 PSI) without valve using supplied test cap.
- Square plasterguard allows for right angle cuts.
- Thin wall mounting.
- For use with MultiChoice® Universal single or dual function trim. Cartridge ships with trim.
- 1/2" outlets and connections.

Note: No tub outlet in HF model.

Note: Should use proper fitting with each type (copper tubing, iron pipe, and pex fitting).

Note: Should use proper tooling with crimping pex fitting and cold expansion pex models.

Note: IP indicates female 1/2" threaded connections.

Note: UN indicates Universal type fitting and is 1/2" NPT male thread with 1/2" C.W.T. female sweat.

WARRANTY

- Parts and Finish - Lifetime limited warranty; or for commercial purchasers, 10 years for multi-family residential (apartments and condominiums) and 5 years for all other commercial uses, in each case from the date the product is received by the original purchaser or their authorized representative (installation contractor, etc.).
- Electronic Parts and Batteries (if applicable) - 5 years from the date the product is received by the original purchaser or their authorized representative (installation contractor, etc.); or for commercial purchasers, 1 year from the date the product is received by the original purchaser or their authorized representative (installation contractor, etc.). No warranty is provided on batteries.

COMPLIES WITH:

- ASME A112.18.1 / CSA B125.1

Delta Faucet Company
 55 E. 111th Street, Carmel, IN 46280
 350 South Edgeware Road, St. Thomas, ON N5P 4L1
 © 2023 Delta Faucet Company

Delta reserves the right (1) to make changes in specifications and materials, and (2) to change or discontinue models, both without notice or obligation. Dimensions are for reference only. See current full-line price book or www.deltafaucet.com for finish options and product availability.

Specification Sheet for Product:

Kohler K-99539-1WM

**Walnut Flax Jute 24" Vanity Cabinet Only - Wall Mounted / Floating
Installation Type**

Features

- Catalyzed conversion varnish provides a durable moisture-resistant finish.
- Furniture-style inset construction for doors.
- Two single doors.
- Three-way adjustable slow-close door hinges with 110-degree opening capability for easy cabinet access.
- Door pulls are sold separately.
- Coordinates with other products in the Jute™ collection.
- Wall-hung design offers a clean, streamlined look.

Material

- Solid wood and veneers.

Recommended Accessories

2791
2777
K-5455 Bathroom Vanity Top
K-5421 Bathroom Vanity Top
K-5436 Bathroom Vanity Top
K-99686 Knob
K-99689 Handle

Optional Accessories

99680
99679
K-99665 Framed Mirror
K-99681 Side Mount Electrical Outlets
K-99682 General Storage
K-99683 Makeup Storage
K-99684 Drawer Dividers
K-99672 Two-Drawer Bridge
K-99668 Lap Drawer
K-99676 Filler Strip
K-99001 Mirrored Cabinet
K-99007 Mirrored Cabinet
K-99009 Mirrored Cabinet
99662
99678



Codes/Standards

CARB P2

KOHLER® One-Year Limited Warranty

See website for detailed warranty information.

Available Color/Finishes

Color tiles intended for reference only.

Color	Code	Description
	1WA	Linen White
	1WN	Corduroy Teak
	1WM	Walnut Flax
	1WJ	Jersey Oak
	1WL	Laurentil Silk
	1WK	Satin Oak
	1WP	Ebony Velour
	1WT	Mohair Grey
	1WU	Batiste Black

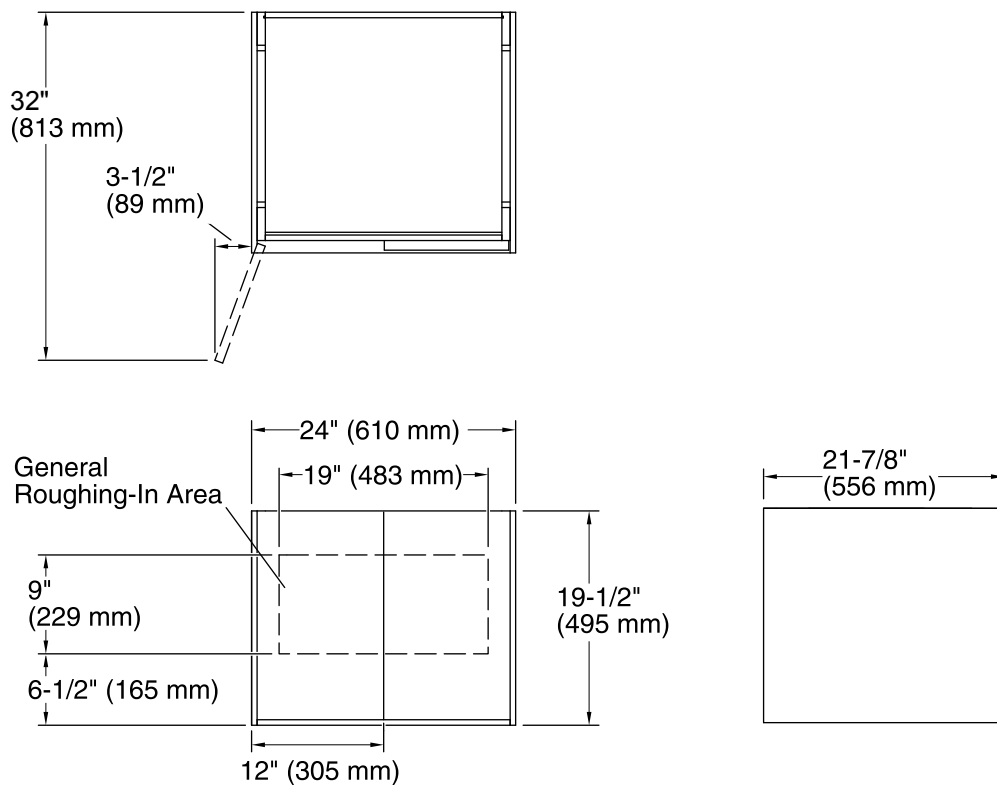

Technical Information

All product dimensions are nominal.

Vanity type: Wall-mount

Notes

Install this product according to the installation guide.

Decorative cabinet hardware is not supplied. Refer to the KOHLER bath accessories line for recommended cabinet hardware to complement your vanity.

Select the type of fastener based upon the wall material. Two 500 lb (227 kg) minimum load bearing fasteners are recommended.

Specification Sheet for Product:

Delta 548LF-SSMPU

**Brilliance Stainless Bowery 1.2 GPM Single Hole Bathroom Faucet
with Push Button Drain Assembly - Limited Lifetime Warranty**

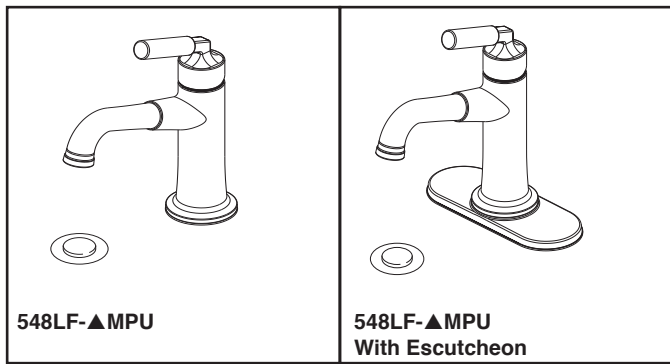

see what Delta can do™

BATHROOM FAUCET

- Bowery™ Collection
- Single Handle Deck Mount

STANDARD SPECIFICATIONS:

- Max. flow rate 1.2 gpm @ 60 psi, 4.5 L/min @ 414 kPa
- Order aerator RP101953-1.0 for maximum 1.0 gpm @ 60 psi, 3.8 L/min @ 414 kPa
- Order aerator RP101953-0.5 for maximum 0.5 gpm @ 60 psi, 1.9 L/min @ 414 kPa
- Solid metal construction
- One or three hole mount (escutcheon optional, included)
- 1/4" O.D. straight, staggered PEX supply tubes
- Diamond coated ceramic cartridge
- Handle motion "Euro Style"
- Optional red/blue indicator ring provided with model
- Models have metal drain with push pop-up type fitting with plated flange and stopper, no lift rod hole

WARRANTY

- Parts and Finish - Lifetime limited warranty; or for commercial purchasers, 10 years for multi-family residential (apartments and condominiums) and 5 years for all other commercial uses, in each case from the date the product is received by the original purchaser or their authorized representative (installation contractor, etc.).
- Electronic Parts and Batteries (if applicable) - 5 years from the date the product is received by the original purchaser or their authorized representative (installation contractor, etc.); or for commercial purchasers, 1 year from the date the product is received by the original purchaser or their authorized representative (installation contractor, etc.). No warranty is provided on batteries.



COMPLIES WITH:

- ASME A112.18.1 / CSA B125.1
- ASME A112.18.2 / CSA B125.2
- Indicates compliance to ICC / ANSI A117.1
- EPA WaterSense® - 1.2 GPM models only

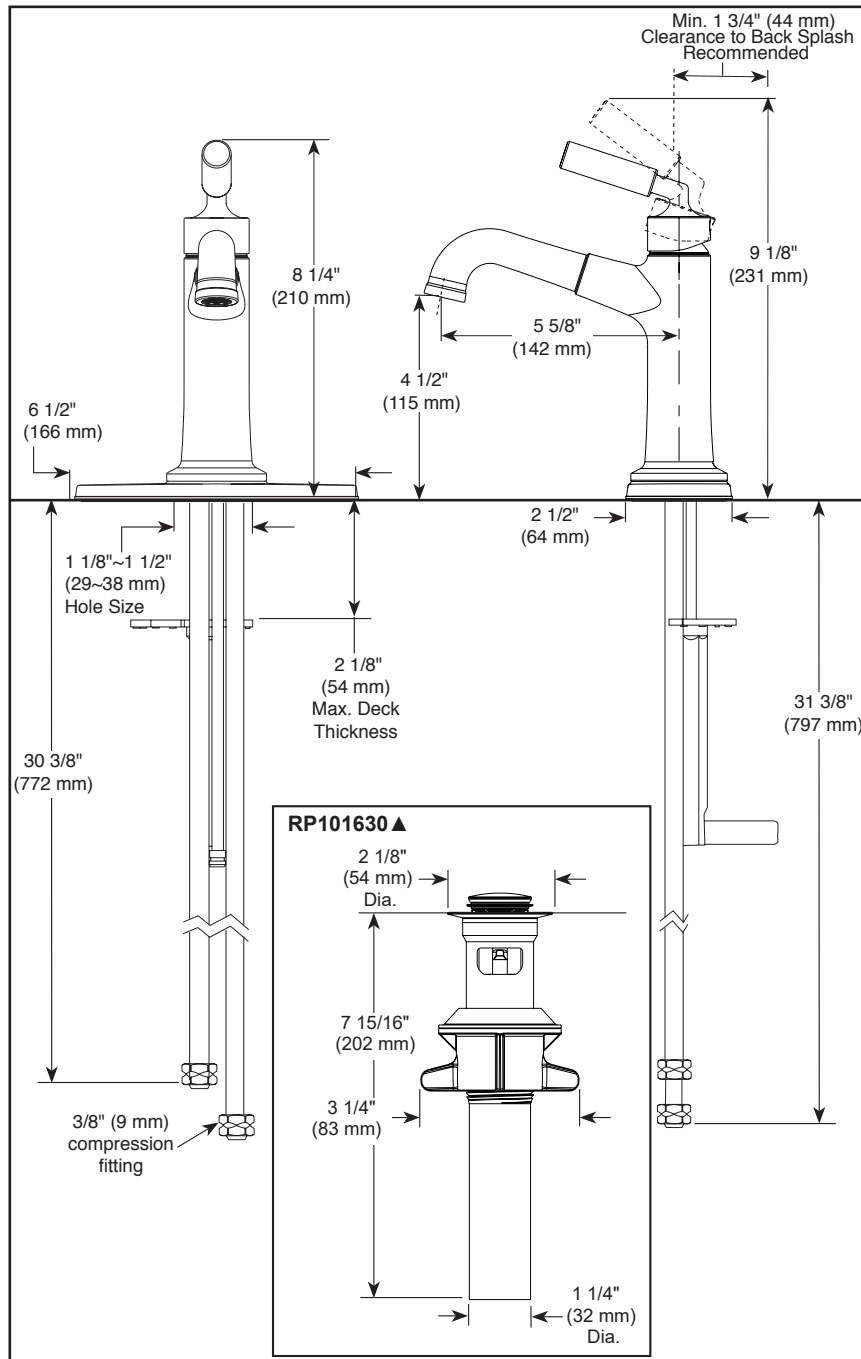

▲ Designate proper finish suffix

Delta reserves the right (1) to make changes in specifications and materials, and (2) to change or discontinue models, both without notice or obligation. Dimensions are for reference only. See current full-line price book or www.deltafaucet.com for finish options and product availability.

DSP-L-548LF-MPU Rev. C

Delta Faucet Company

55 E. 111th Street, Indianapolis, IN 46280
 350 South Edgeware Road, St. Thomas, ON N5P 4L1
 © 2023 Delta Faucet Company

Specification Sheet for Product:

Delta T14048-SS

**Brilliance Stainless Bowery Monitor 14 Series Single Function
Pressure Balanced Shower Trim - Less Rough-In Valve**

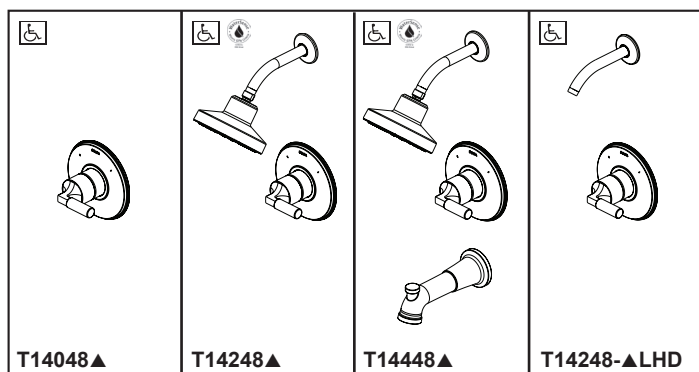

Submitted Model No.: _____

Specific Features: _____

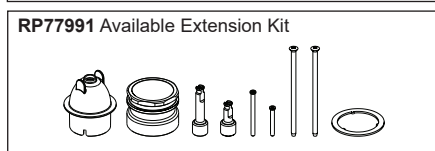
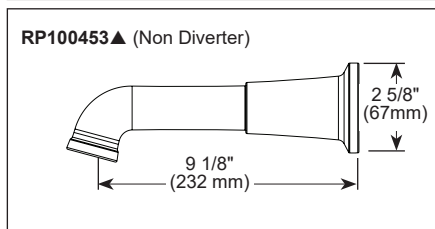
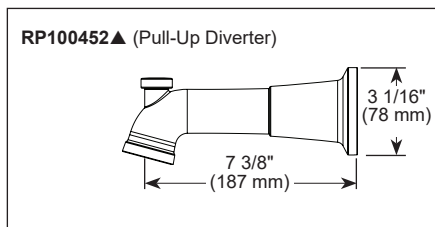
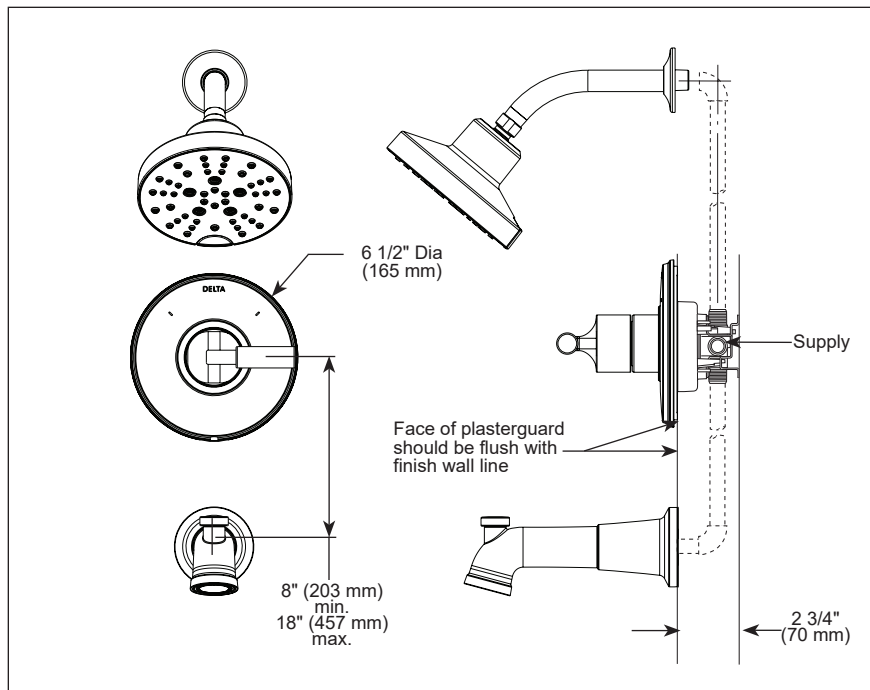

52668 ▲ 1.75 GPM H₂O Showerhead



Full Body Spray



H2Okinec Spray



Pause



Full Spray w/Massage



Massage Spray

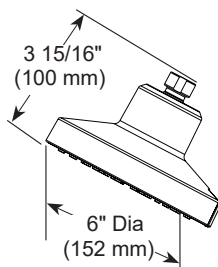

see what Delta can doSM TUB AND SHOWER FAUCET TRIM

- Bowery™ Bath Collection
- Valve Only (T14048)
- Shower Only (T14248)
- Tub/Shower (T14448)

FEATURES:

- Monitor® 14 Series pressure balanced bath single handle mixing valve trim
- Five-setting H₂Okinec® Technology showerhead

STANDARD SPECIFICATIONS:

- Maintains a balanced pressure of hot and cold water even when a valve is turned on or off elsewhere in the system.
- For use with MultiChoice® Universal rough valve body. (R10000 Series)
- Back-to-back installation capability.
- Temperature only controlled with handle.
- Field adjustable to limit handle rotation into hot water zone.
- 120° maximum handle rotation.
- All parts replaceable from the front of the valve.
- Maximum 1.75 gpm @ 80 psi, 7.60 L/min @ 550 kPa.
- Tub port max flow rate 6.0 gpm at 60 psi with R10000-UNBX
- Red/blue pad print temperature indicator on the shower escutcheon.
- "LHD" models indicate less showerhead.
- Stem extension kit RP77991 can be ordered to allow for an additional 1 3/4" wall thickness.
- Shower arm overall horizontal length = 7" (178mm), including threaded ends

WARRANTY

- Parts and Finish – Lifetime limited warranty; or for commercial purchasers, 10 years for multi-family residential (apartments and condominiums) and 5 years for all other commercial uses, in each case from the date of purchase.
- Electronic Parts and Batteries (if applicable) – 5 years from the date of purchase; or for commercial purchasers, 1 year from the date of purchase. No warranty is provided on batteries.

COMPLIES WITH:

- ASME A112.18.1 / CSA B125.1
- ☑ Indicates compliance to ICC/ANSI A117.1-Valve control only.
- EPA WaterSense®

▲ Designate Proper Finish Suffix

Delta reserves the right (1) to make changes in specifications and materials, and (2) to change or discontinue models, both without notice or obligation. Dimensions are for reference only. See current full-line price book or www.deltafaucet.com for finish options and product availability.

DSP-B-T14048 Rev. A

Delta Faucet Company

55 E. 111th Street, Indianapolis, Indiana 46280
350 South Edgeware Road, St. Thomas, ON N5P 4L1
© 2018 Delta Faucet Company

Specification Sheet for Product:

Delta 58472-SS-PR

**Lumicoat Stainless Universal Showering Round 2.5 GPM Multi
Function 2-in1 In2ition Shower Head and Hand Shower with
H2Okinetic and MagnaTite Technology**

Submitted Model No.: _____

Specific Features: _____



see what Delta can do™

IN2ITION®

- H₂Okinetic® 2-In-1 Shower
- 4-Spray Settings Hand Shower

FEATURES:

- Push Button Selection
- MagnaTite® Docking
- H₂Okinetic® PowerDrench Spray
- Lumicoat™ Finish (-PR models only)
- Lumicoat™ Finishes easily wipe clean without cleaners and chemicals on the products most commonly touched areas

STANDARD SPECIFICATIONS:

- Max. flow rate 2.5 gpm @ 80 psi, 9.5 L/min @ 550 kPa
- Integrated hand shower docks securely into shower head when not in use
- 4 hand shower spray settings - pause is a non-positive shut-off
- 3-Way diverter for single or shared operation of the shower head and hand shower
- Fixed shower head and hand shower all in one
- Change spray modes with push button
- 60" (1524 mm) stretchable metal hose, stretches to 82" (2083 mm) for extra reach
- Lumicoat™ is not applied to the shower hose

WARRANTY

- Parts and Finish - Lifetime limited warranty; or for commercial purchasers, 10 years for multi-family residential (apartments and condominiums) and 5 years for all other commercial uses, in each case from the date of purchase.
- Electronic Parts and Batteries (if applicable) - 5 years from the date of purchase; or for commercial purchasers, 1 year from the date of purchase. No warranty is provided on batteries.

COMPLIES WITH:

- ASME A112.18.1 / CSA B125.1
- ASME A112.18.3

◆ Your Delta Faucet handshower incorporates a backflow protection system that has been tested to be in compliance with ASME A112.18.3 and ASME A112.18.1/CSA B125.1. It incorporates two certified check valves in series, which operate independently and are integral, nonserviceable parts of the wand assembly.

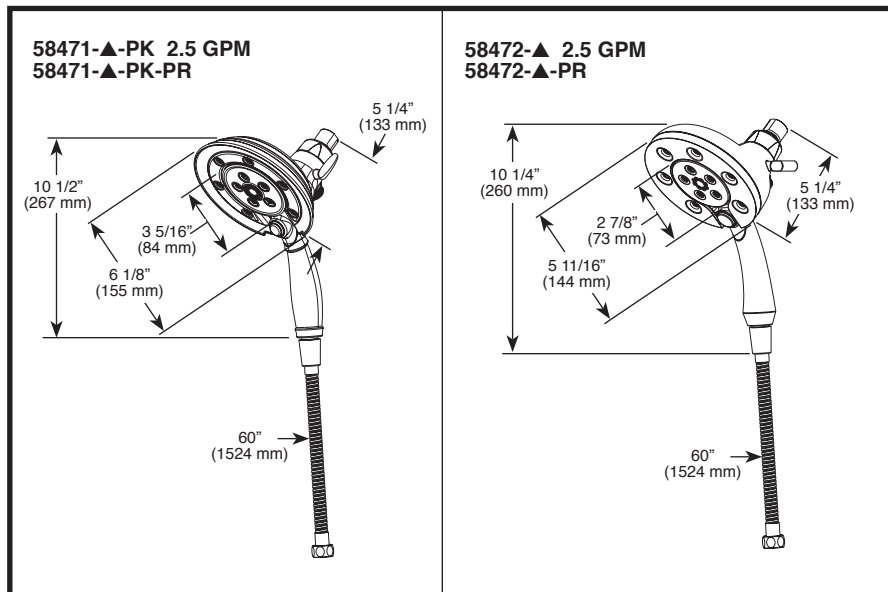

▲ Designate proper finish suffix

Specification Sheet for Product:
Ebbe America E4024
N/A PVC Clamp Collar Drain Bundle

E4022/E4024 DRAIN KIT



MEETS: IAPMO IGC 195-2013a &
ASME A112.18.2 /CSA B125.2
STANDARDS

THE INFORMATION CONTAINED IN THIS DRAWING IS
THE SOLE PROPERTY OF EBBE AMERICA LC.. ANY
REPRODUCTION IN PART OR AS A WHOLE WITHOUT
THE WRITTEN PERMISSION OF EBBE AMERICA IS
PROHIBITED. ebbe-america.com/patent

E4022-ABS E4024-PVC Drain Assembly

Component	QTY	Material
Drain Body	1	ABS or PVC
Clamping Ring	1	ABS or PVC
1/4-20 Bolt	4	Stainless
Riser Body	1	ABS
Construction Debris Plug	1	ABS
Hair trap	1	PP

NOTE: Not For Use In Hot Mop Applications

Total Assembled Weight .75 lbs

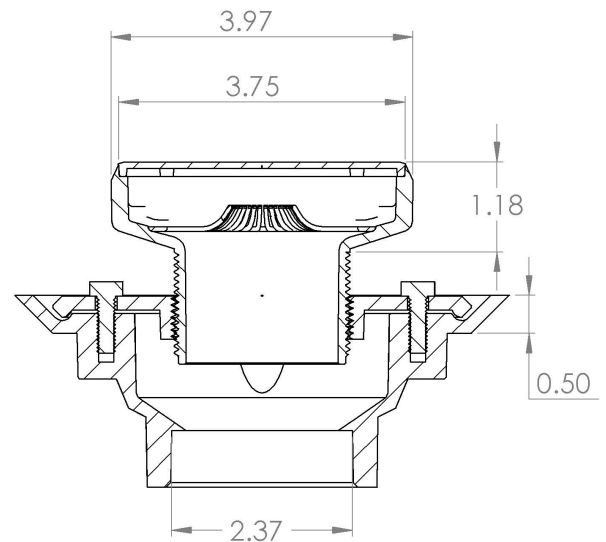
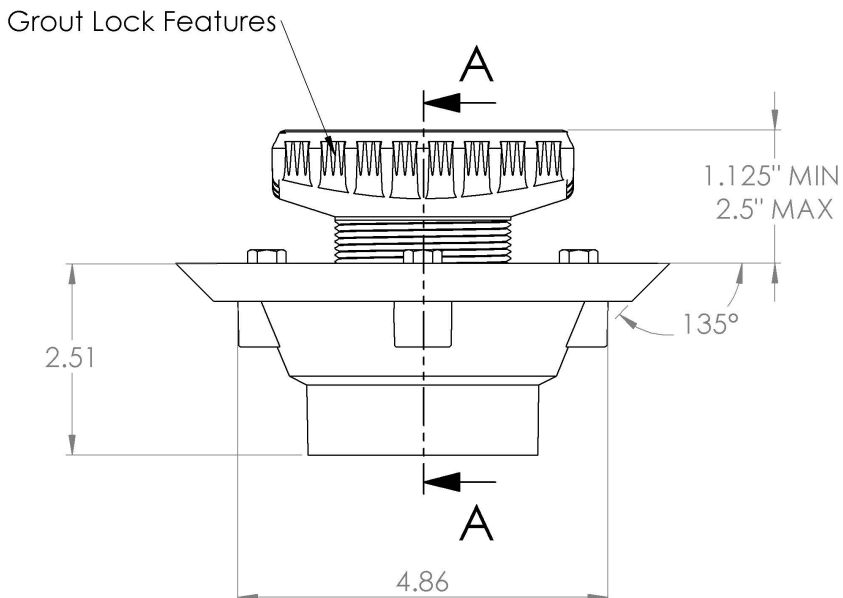
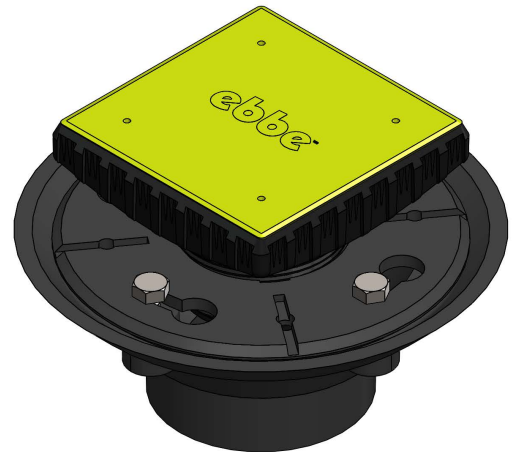
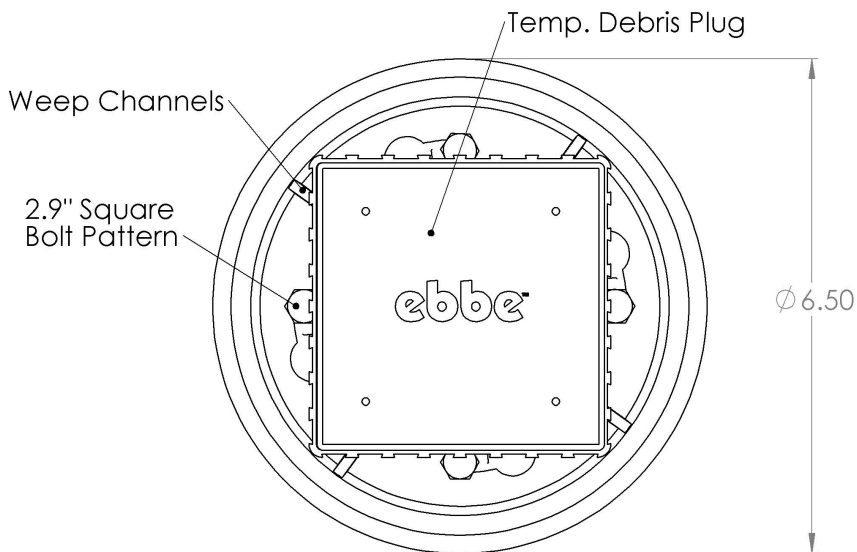

SECTION A-A

Specification Sheet for Product:
Ebbe America E4404
Brushed Nickel PRO Drain Cover - Brushed Nickel

E4401 - E4410

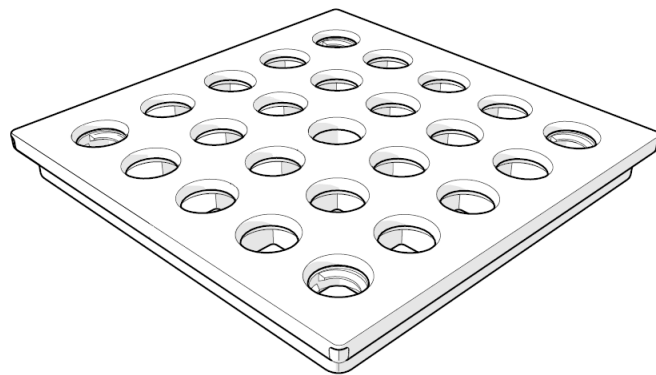
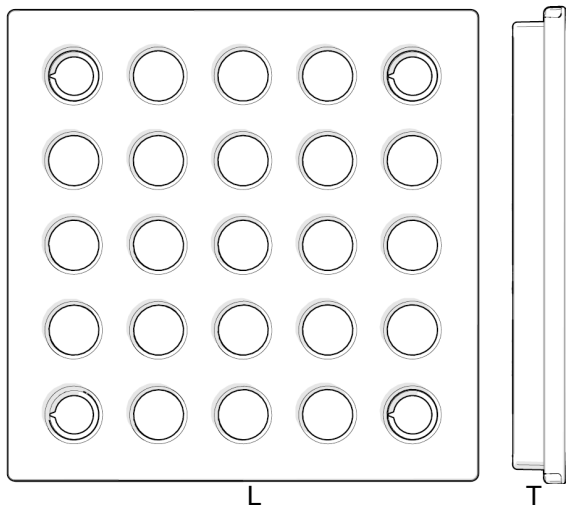

ebbe
PRO

Length (L)	3.75 in
Thickness (T)	0.43 in
Total Open Area	3.16 in ²
GPM	11
Material	Stainless Clad/Polycarbonate
Weight	2.50 oz

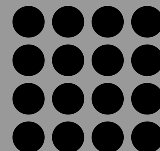

Specification Sheet for Product:

TOTO MS646234CEMFGN#01

**Cotton Aquia IV 0.9 / 1.28 GPF Dual Flush One Piece Elongated
Toilet with Push Button Flush - Seat Included**

Aquia® IV One-Piece Toilet - 1.28 & 0.9 GPF

FEATURES

- DYNAMAX TORNADO FLUSH® utilizes 360° cleaning power to reach every part of the bowl
- Ultra high-efficiency dual flush 1.28 & 0.9 GPF (4.8 & 3.4 LPF)
- CEFIONTECT® ceramic glaze minimizes waste from sticking to porous ceramic surfaces
- Completely skirted design for a sleek and understated look that's easier to clean
- Specially designed to accommodate a WASHLET®+
- Elongated front bowl toilet and seat set
- UNIVERSAL HEIGHT
- Chrome push-button
- 12" Rough-in

MODELS

- **MS646234CEMFGN (#01)**
With CEFIONTECT ceramic glaze & includes SS234 SoftClose® seat

OPTIONAL COMPONENTS

- **SS124**
SoftClose® Seat
- **TSU48.10**
10" Unifit Rough-In
- **TSU48.14**
14" Unifit Rough-In
- **THU848#01-A**
Push Button Assembly - Cotton
- **THU848#PN-A**
Push Button Assembly - Polished Nickel
- **THU848#BN-A**
Push Button Assembly - Brushed Nickel

COLORS/FINISHES

- #01 Cotton



**DYNAMAX
TORNADO FLUSH**



U UNIVERSAL HEIGHT



CEFIONTECT

PRODUCT SPECIFICATION

The one-piece, ultra high-efficiency, DYNAMAX TORNADO FLUSH toilet shall be dual flush 1.28 GPF/0.9 GPF. Toilet shall be coated with CEFIONTECT, elongated front bowl, high profile tank, UNIVERSAL HEIGHT, complete skirted bowl and chrome push-button.

Toilet shall be TOTO Model MS646234CEMFGN#01.

CODES/STANDARDS

- Meets and exceeds ASME A112.19.2/CSA B45.1, ASME A112.19.14
- Certifications: IAPMO(cUPC®), EPA WaterSense, State of Massachusetts and others
- Code Compliance: UPC, IPC, NSPC, NPC Canada, and others
- Legislative Compliance: California Green Building Code, City of Los Angeles Water Efficiency Ordinance, and others
- Complies with CA Prop 65 warning requirements



©2010 TOTO

MS646234CEMFGN

Aquia® IV One-Piece Toilet - 1.28 & 0.9 GPF

SPECIFICATIONS

Water Use	1.28 & 0.9 GPF (4.8 & 3.4 LPF)
Flush System	DYNAMAX TORNADO FLUSH®
Min. Water Pressure	8 psi (Flowing)
Water Surface	7" x 5"
Trap Diameter	2-1/4"
Rough-in	12" (10" and 14" options available)
Trap Seal	2-1/8"
Warranty	One Year Limited Warranty
Material	Vitreous China
Shipping Weight	118 lbs.
Shipping Dimensions	29-1/2" L x 17-5/8" W x 28-1/8" H

INSTALLATION NOTES

Back-to-Back Toilet Installations:

TOTO recommends the use of a nationally listed, double sanitary tee-wye only, in vertical waste stacks, in accordance with the stipulations noted in the majority of nationally recognized plumbing codes.

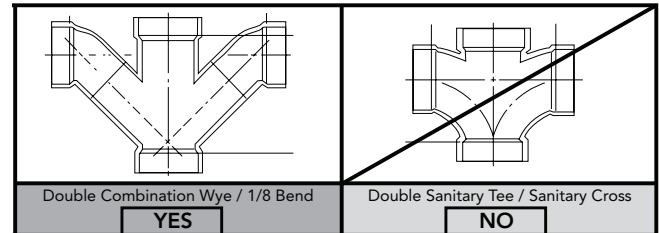

To maintain adequate wall gap between the back of the tank and wall, mount the floor flange at a nominal 12" rough-in distance.

DIMENSIONS

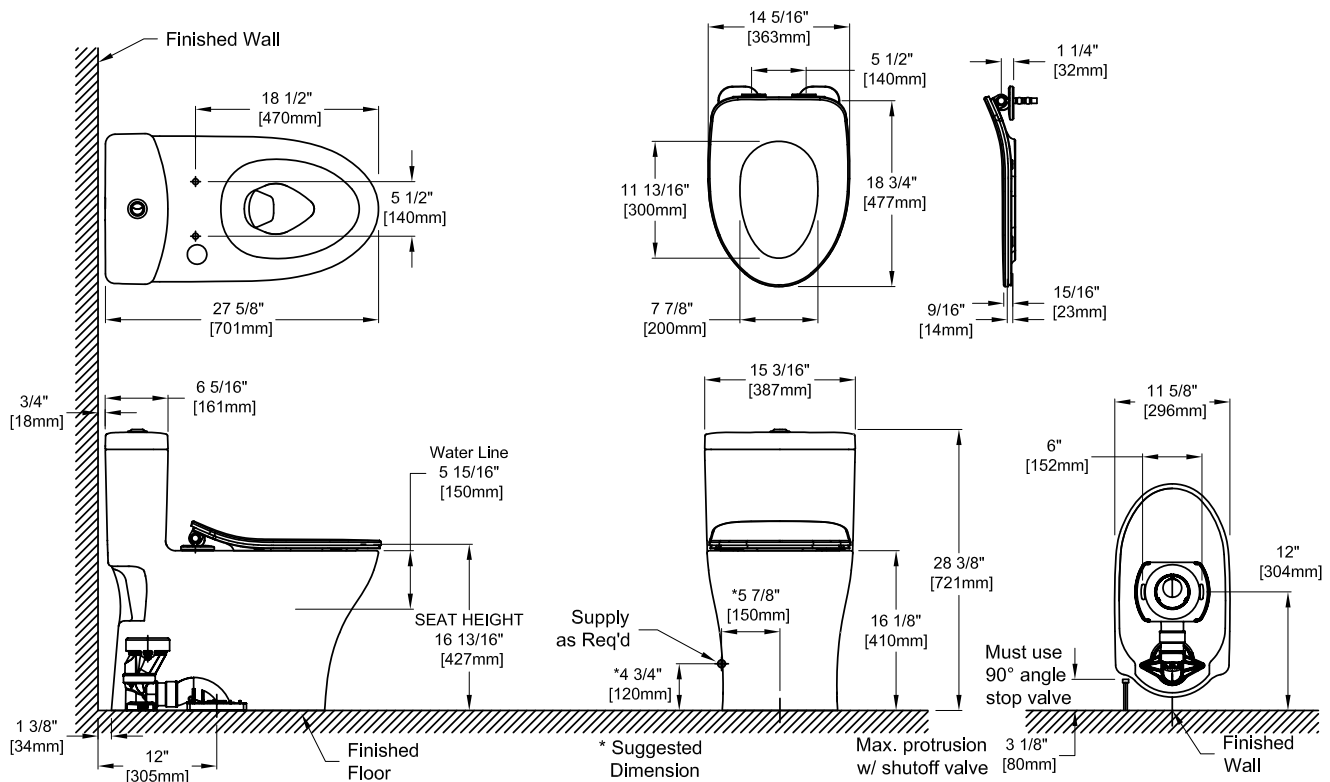

TOTO®

These dimensions and specifications are subject to change without notice

Specification Sheet for Product:
Delta 74835-SS
Brilliance Stainless Bowery Single Robe Hook



see what Delta can do™

ACCESSORIES

- Bowery™ Collection
- Robe Hook

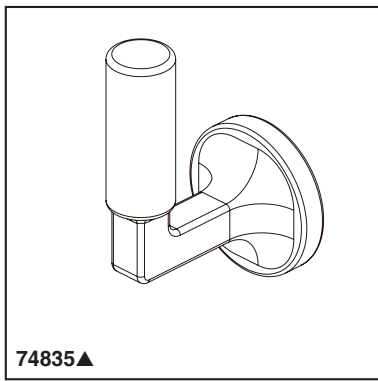

74835▲

Submitted Model No.: _____

Specific Features: _____

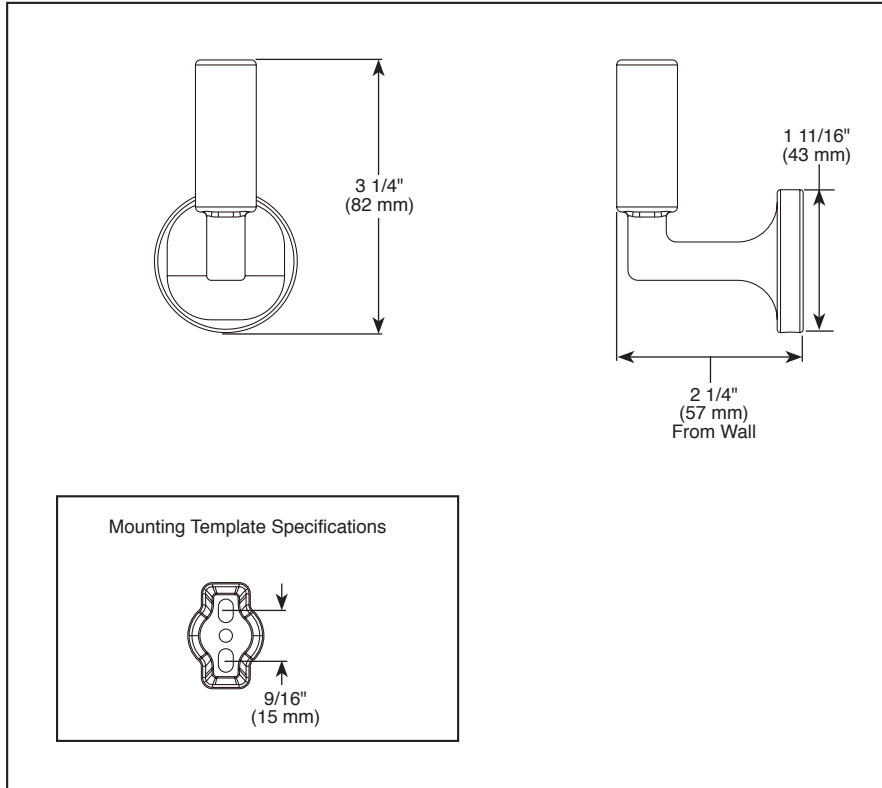

STANDARD SPECIFICATIONS:

- Wood blocking is preferable behind all wall surfaces. If wood blocking is not available, the following fasteners are suggested: Tile/Masonry-plastic or lead anchors plaster/drywall-Toggle bolts.
- Mounting hardware included with product.

WARRANTY

- Parts and Finish – Lifetime limited warranty; or for commercial purchasers, 10 years for multi-family residential (apartments and condominiums) and 5 years for all other commercial uses, in each case from the date of purchase.
- Electronic Parts and Batteries (if applicable) – 5 years from the date of purchase; or for commercial purchasers, 1 year from the date of purchase. No warranty is provided on batteries.

▲ Designate Proper Finish Suffix

Specification Sheet for Product:

Delta 74808-SS

**Brilliance Stainless Bowery 8" Towel Bar - Limited Lifetime
Warranty**



see what Delta can do™

ACCESSORIES

■ Bowery™ Collection

■ 8" Towel Bar

■ 18" Towel Bar

■ 24" Towel Bar

■ 30" Towel Bar

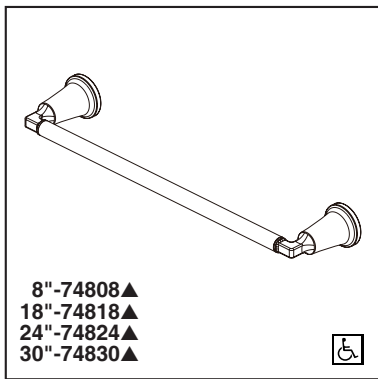

Submitted Model No.: _____

Specific Features: _____

STANDARD SPECIFICATIONS:

- Wood blocking is preferable behind all wall surfaces. If wood blocking is not available, the following fasteners are suggested: Tile/Masonry-plastic or lead anchors plaster/drywall-Toggle bolts.
- Mounting hardware included with product.

WARRANTY

- Parts and Finish – Lifetime limited warranty; or for commercial purchasers, 10 years for multi-family residential (apartments and condominiums) and 5 years for all other commercial uses, in each case from the date of purchase.
- Electronic Parts and Batteries (if applicable) – 5 years from the date of purchase; or for commercial purchasers, 1 year from the date of purchase. No warranty is provided on batteries.

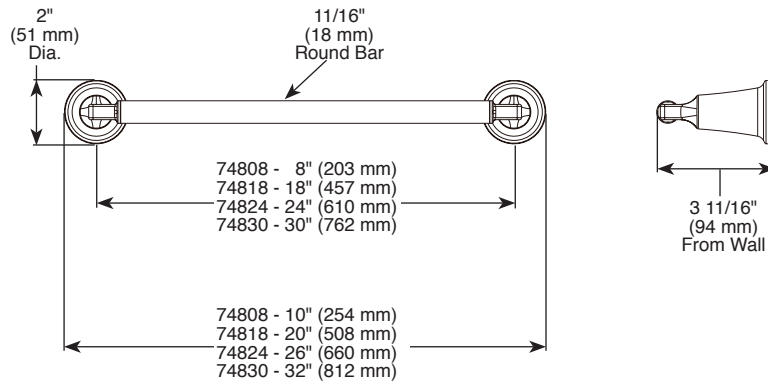

Mounting Template Specifications

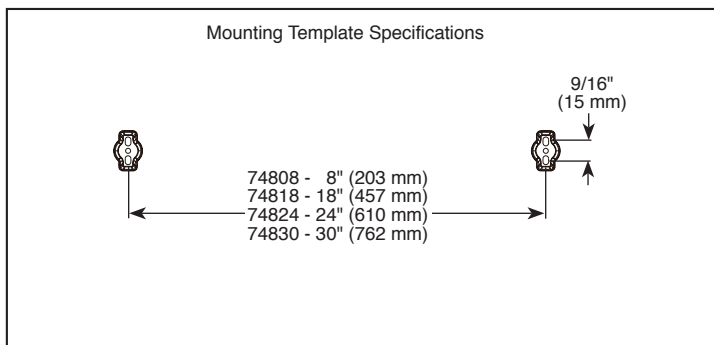

▲ Designate Proper Finish Suffix

Delta reserves the right (1) to make changes in specifications and materials, and (2) to change or discontinue models, both without notice or obligation. Dimensions are for reference only. See current full-line price book or www.deltafaucet.com for finish options and product availability.

DSP-A-74808 Rev. A

Delta Faucet Company

55 E. 111th Street, Indianapolis, Indiana 46280
350 South Edgeware Road, St. Thomas, Ontario Canada N5P 4L1
© 2018 Delta Faucet Company

Specification Sheet for Product:

Kohler K-28246-MMW

**Miami White Silestone Quartz 25" Vanity Top with Rectangle
Cutout**



Silestone® quartz 25" vanity top w/ rectangle cutout K-28246

Features

- Designed for use with compatible 24" (610 mm) KOHLER® vanities (sold separately).
- Available in many classic and warm neutral tones to work seamlessly in any decor.
- Pairs beautifully with select KOHLER® and Artist Editions® sinks for a complete solution.
- ½" (12.7 mm) countertop overhang per side.
- Flat, square edges give a crisp, finished look.
- Optional side and backsplashes available (sold separately).
- This product is covered under the Silestone® 25-Year Limited Warranty.



Material

- Silestone® quartz.
- Silestone® quartz.

Installation

- Vanity top.
- Single faucet hole with pilot holes for optional 8" (203 mm) widespread faucet configuration.

Recommended Products/Accessories

K-2882 Undermount bathroom sink
K-2330 Undermount bathroom sink
K-20000 Undermount bathroom sink

Optional Products/Accessories

K-28261 Silestone® quartz 25" backsplash
K-28266 Silestone® quartz side splash

Included Components

Additional Components:
Mounting Screws

Codes/Standards





None Applicable

KOHLER® One-Year Limited Warranty

See website for detailed warranty information.

Available Colors/Finishes

Color tiles intended for reference only.

Color	Code	Description
	ESR	ET Serena
	EMQ	ET Marquina
	EST	ET Statuario
	MMW	Miami White
	IBZ	



Silestone® quartz 25" vanity top w/ rectangle cutout
K-28246

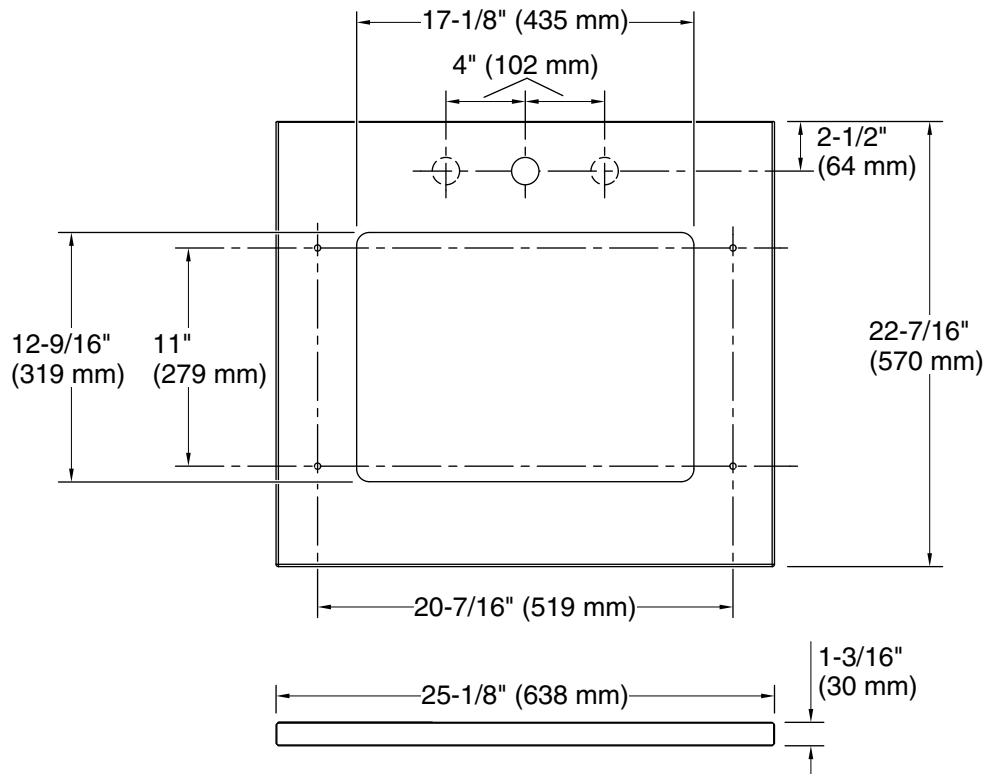

Technical Information

All product dimensions are nominal.

Installation: Vanity top/ITB

Number of deck holes: 1

Notes

Install this product according to the installation instructions.

Specification Sheet for Product:

Kohler K-99688-HF2

Satin Jute 3 Inch Center to Center Rectangular Cabinet Pull



Jute™
Bar Pull
K-99688

Features

- Premium metal construction for durability.
- Available in Chrome, Brushed, and Black finishes.
- Designed to complement the modern style of Jute™ vanities.



Codes/Standards

None Applicable

KOHLER® One-Year Limited Warranty

See website for detailed warranty information.

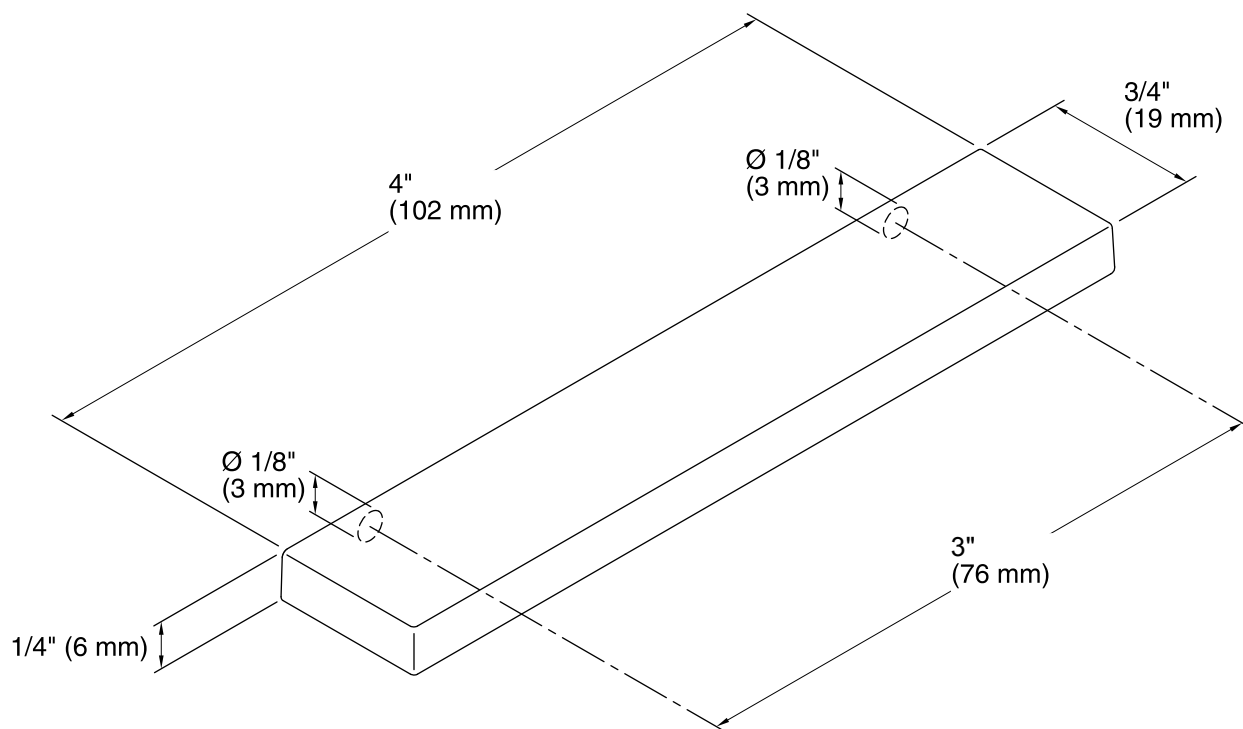

Technical Information

All product dimensions are nominal.

Specification Sheet for Product:

Kohler K-20000-0

**White Caxton Rectangle 20-1/4" Undermount Bathroom Sink with
Overflow**



Caxton® Rectangle

Under-mount Bathroom Sink

K-20000

Features

- Rectangular basin.
- Overflow drain.
- No faucet holes; requires wall- or counter-mount faucet.

Material

- Vitreous china.

Installation

- Under-mount

Included Components

Product consists of:

1193643 Basin clamps



ADA

CSA B651

Codes/Standards

ASME A112.19.2/CSA B45.1

ADA

ICC/ANSI A117.1











CSA B651

KOHLER® One-Year Limited Warranty

See website for detailed warranty information.

Available Colors/Finishes

Color tiles intended for reference only.

Color	Code	Description
	0	White
	96	Biscuit
	47	Almond
	NY	Dune
	95	Ice™ Grey
	G9	Sandbar
	33	Mexican Sand™
	K4	Cashmere
	58	Thunder™ Grey
	7	Black Black™

1-800-4KOHLER (1-800-456-4537)

Kohler Co. reserves the right to make revisions without notice to product specifications.

For the most current Specification Sheet, go to www.kohler.com.

12-7-2019 09:11 - US/CA/MX

THE BOLD LOOK
OF **KOHLER**®



Caxton® Rectangle

Under-mount Bathroom Sink

K-20000

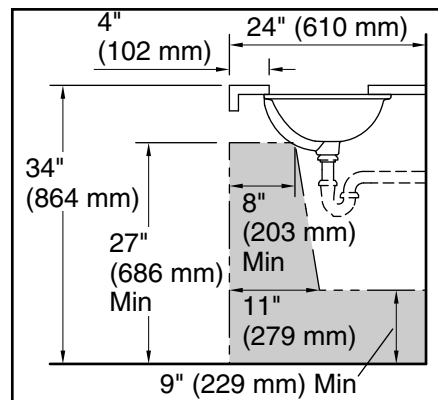
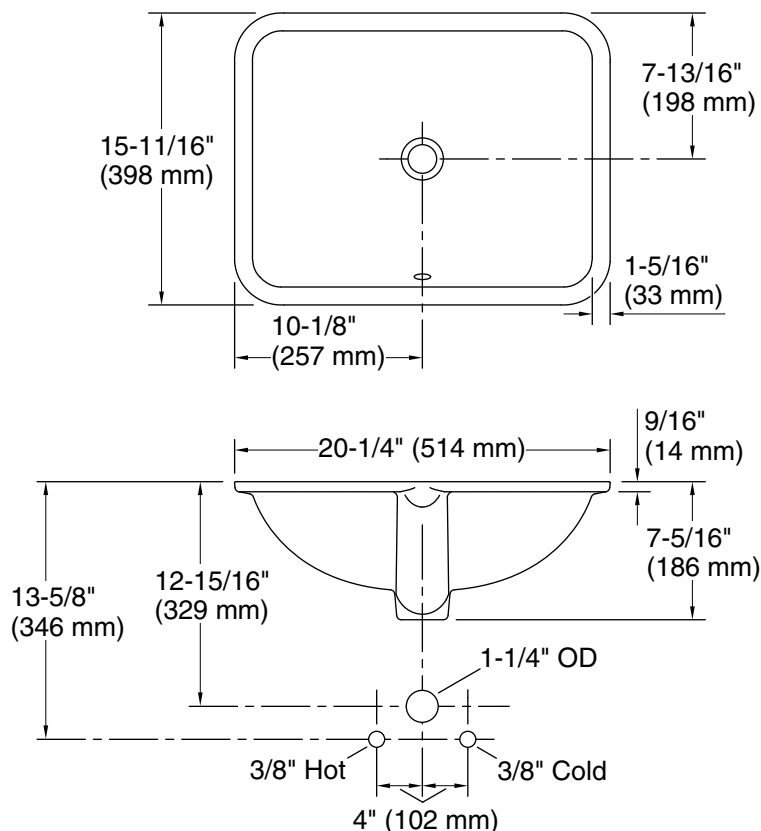

Recommended ADA Installation

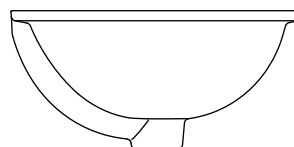

Technical Information

All product dimensions are nominal.

Installation:	Under-mount
Bowl area:	Length: 17-5/8" (448 mm) Width: 13-1/8" (334 mm) Bowl depth: 5-5/16" (135 mm) Water depth: 3-5/8" (93 mm)
Drain hole:	1-3/4" (44 mm)
Template:	Under-mount, 1281904-7, required, not included

Notes

Install this product according to the installation instructions.

Countertop manufacturer or cutter must use the cut-out template provided with the product, or a current one provided by Kohler Co. (call 1-800-43-FOCUS). Kohler Co. is not responsible for cut-out errors when the incorrect cut-out template is used.

ADA, CSA B651 compliant when installed to the specific requirements of these regulations.

Specification Sheet for Product:

Delta R10000-UNBX

**N/A Universal Mixing Rough-In Valve with 1/2" NPT Male thread
with 1/2" C.W.T Female Sweat - Box Model**

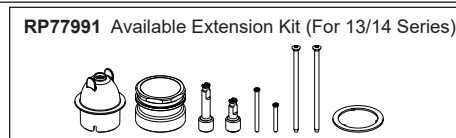
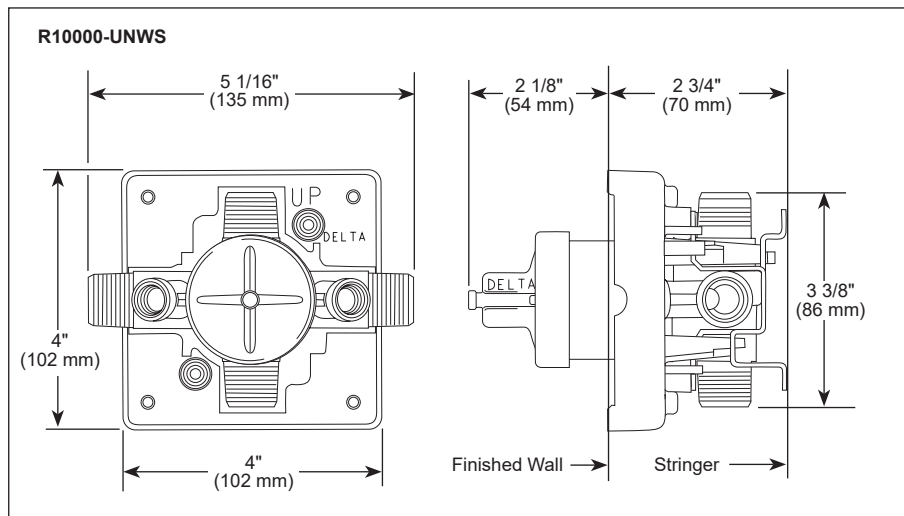
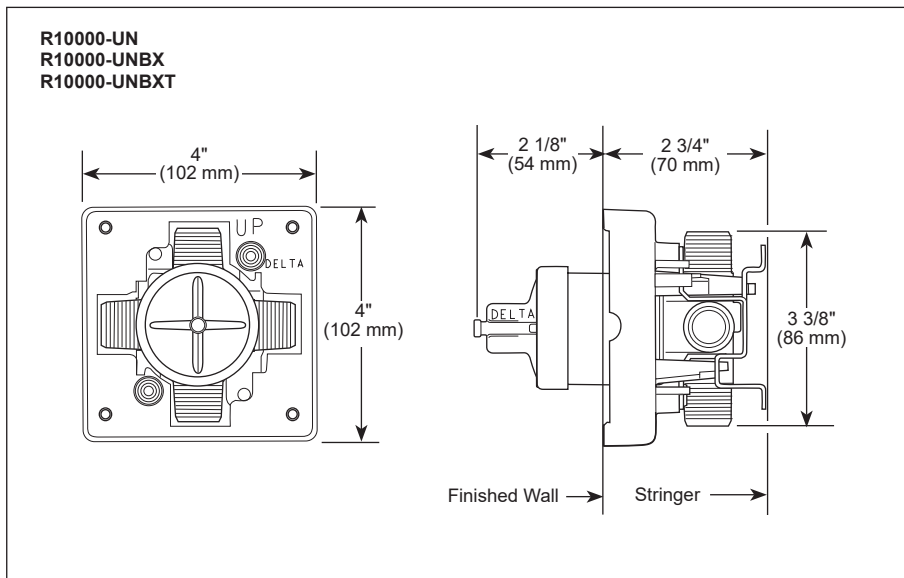
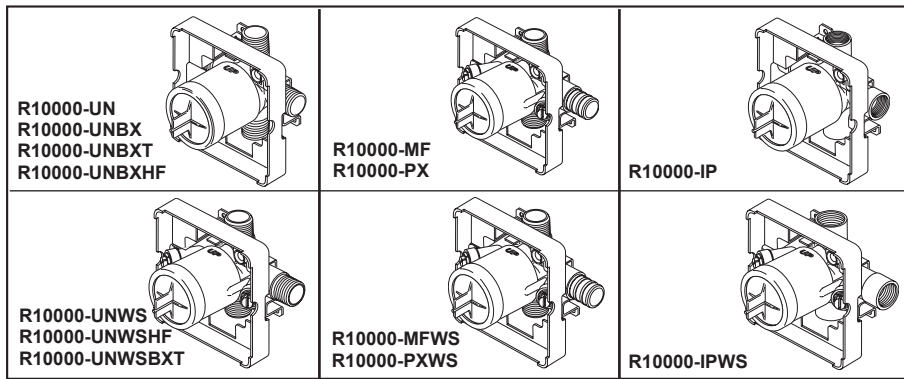

see what Delta can do™ **MULTICHOICE®** **UNIVERSAL ROUGH** **VALVE BODY**

- R10000-UN (Universal Inlets/Outlets)
- R10000-UNBX (Universal Single Box Model)
- R10000-UNBXHF (High Flow Shower Only)
- R10000-UNBXT (Thin Wall)
- R10000-UNWS (Universal with Stops)
- R10000-UNWSHF (High Flow with Stops)
- R10000-UNWSBXT (Thin Wall with Stops)
- R10000-PX (Pex Crimp Connections with UN Outlets)
- R10000-PXWS (Pex Crimp Connections with Stop with UN Outlets)
- R10000-IP (IPS Inlets/Outlets)
- R10000-IPWS (IPS with Stops)
- R10000-MF (Pex Cold Expansion Connections with UN Outlets)
- R10000-MFWS (Pex Cold Expansion with Stops with UN Outlets)

STANDARD SPECIFICATIONS:

- Forged brass body.
- Back-to-Back installation capabilities.
- Can be tested with air (200 PSI) or water (300 PSI) without valve using supplied test cap.
- Square plasterguard allows for right angle cuts.
- Thin wall mounting.
- For use with MultiChoice® Universal single or dual function trim. Cartridge ships with trim.
- 1/2" outlets and connections.

Note: No tub outlet in HF model.

Note: Should use proper fitting with each type (copper tubing, iron pipe, and pex fitting).

Note: Should use proper tooling with crimping pex fitting and cold expansion pex models.

Note: IP indicates female 1/2" threaded connections.

Note: UN indicates Universal type fitting and is 1/2" NPT male thread with 1/2" C.W.T. female sweat.

WARRANTY

- Parts and Finish - Lifetime limited warranty; or for commercial purchasers, 10 years for multi-family residential (apartments and condominiums) and 5 years for all other commercial uses, in each case from the date the product is received by the original purchaser or their authorized representative (installation contractor, etc.).
- Electronic Parts and Batteries (if applicable) - 5 years from the date the product is received by the original purchaser or their authorized representative (installation contractor, etc.); or for commercial purchasers, 1 year from the date the product is received by the original purchaser or their authorized representative (installation contractor, etc.). No warranty is provided on batteries.

COMPLIES WITH:

- ASME A112.18.1 / CSA B125.1

Delta Faucet Company
 55 E. 111th Street, Carmel, IN 46280
 350 South Edgeware Road, St. Thomas, ON N5P 4L1
 © 2023 Delta Faucet Company

Delta reserves the right (1) to make changes in specifications and materials, and (2) to change or discontinue models, both without notice or obligation. Dimensions are for reference only. See current full-line price book or www.deltafaucet.com for finish options and product availability.

Specification Sheet for Product:

Elkay EFRU30169RTWC

**Stainless Steel Crosstown 31-1/2" Undermount Single Basin
Stainless Steel Kitchen Sink with Basin Rack, Basket Strainer,
Colander, and Cutting Board**

PRODUCT SPECIFICATIONS

Elkay Crosstown® 16 Gauge Workstation Stainless Steel 31-1/2" x 18-1/2" x 9", Single Bowl Undermount Sink Kit. Sink is manufactured from 16 gauge 304 Stainless Steel with a Polished Satin finish, Rear Right drain placement, and Full spray sides and bottom with Sides and Bottom pads.

Installation Type:	Undermount
Material:	304 Stainless Steel
Special Features:	Workstation
Finish:	Polished Satin
Gauge:	16
Sound Deadening:	Full spray sides and bottom with Sides and Bottom pads
Number of Bowls:	1
Sink Dimensions:	31-1/2" x 18-1/2" x 9"
Bowl 1 Dimensions:	30" x 17" x 9"
Drain Size:	3-1/2" (89mm)
Drain Location:	Rear Right
Minimum Cabinet Size:	36"
Mounting Hardware:	Part # 54300308 included
Template Included:	Yes
Cutout Template #:	1000001381

Template is available for download at [elkay.com](#). CAD software will be required to open the template.

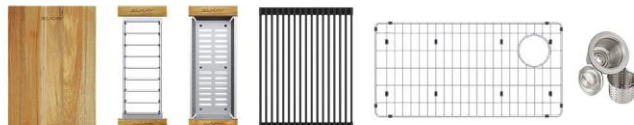

Included with Product: CTXBG2814 bottom grid, LKC0717SS colander, LKCB1217AC Cutting Board, LKDR1317RU drying rack, LKDR0717SS drying rack, LKDD drain

AMERICAN PRIDE. A LIFETIME TRADITION.
Like your family, the Elkay family has values and traditions that endure. For almost a century, Elkay has been a family-owned and operated company, providing thousands of jobs that support our families and communities.

Product Compliance: ASME A112.19.3/CSA B45.4
Accessory: ASME A112.18.2/CSA B125.2

Installation Profile:

FLUSH

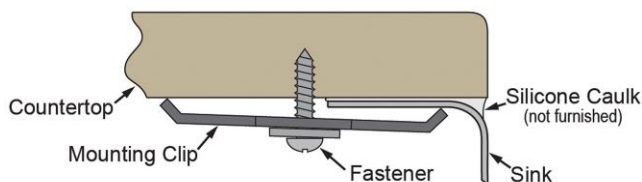

Designed to affix to the underside of any solid surface countertop.



Sinks are listed by IAPMO® as meeting the applicable requirements of the Uniform Plumbing Code®, International Plumbing Code®, and National Plumbing Code of Canada.

[Clean and Care Manual \(PDF\)](#)
[Installation Instructions \(PDF\) - 1000005239](#)
[Installation Instructions \(PDF\) - 1000005235 drain](#)
[Installation Instructions \(PDF\) - Warranty \(PDF\)](#)

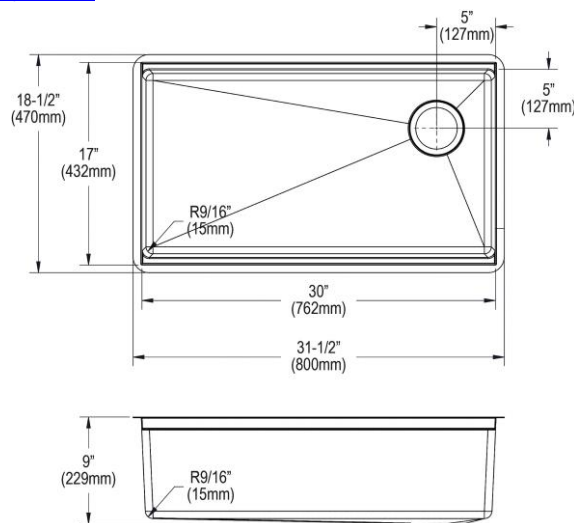

PART: _____ QTY: _____
PROJECT: _____
CONTACT: _____
DATE: _____
NOTES: _____
APPROVAL: _____

In keeping with our policy of continuing product improvement, Elkay reserves the right to change product specifications without notice. Please visit [elkay.com](#) for the most current version of Elkay product specification sheets. This specification describes an Elkay product with design, quality, and functional benefits to the user. When making a comparison of other producers' offerings, be certain these features are not overlooked.

OPTIONAL ACCESSORIES

Hardware:	LKUCLIP8 (2 Required)
-----------	-----------------------

In keeping with our policy of continuing product improvement, Elkay reserves the right to change product specifications without notice. Please visit elkay.com for the most current version of Elkay product specification sheets. This specification describes an Elkay product with design, quality, and functional benefits to the user. When making a comparison of other producers' offerings, be certain these features are not overlooked.

Specification Sheet for Product:
Moen 87233SRS
Spot Resist Stainless Adler 1.5 GPM Single Hole Pull Down
Kitchen Faucet

DESCRIPTION

- Reflex™ pulldown system offers smooth operation, easy movement and secure docking
- Metal construction with Spot Resist™ finish
- Duralock™ quick connect installation
- Power Clean™ Technology for more force, less splash
- Pulldown spray with 68" braided hose
- 3/8" compression connections will accept standard ball nose connection for 3/8" tubing

OPERATION

- Lever style handle
- Operates with less than 5 lbs. of force
- Operates in stream or spray mode in the pulldown or retracted position

FLOW

- Flow is limited to 1.5 gpm (5.7 L/min) at 60 psi

CARTRIDGE

- 1255™ Duralast™ cartridge for Single-Handle Faucets
- Engineered polymers, non-ferrous and stainless steel materials

STANDARDS

- Third party certified to IAPMO Green, ASME A112.18.1/CSA B-125.1 and all applicable requirements referenced therein including NSF 61/9 & 372
- Meets CalGreen and Georgia SB370 requirements
- Complies with California Proposition 65 and with the Federal Safe Drinking Water Act
- ADA  for lever handle
- The backflow protection system in this device consists of two independently operating check valves, a primary and a secondary which prevent backflow

WARRANTY

- Lifetime limited warranty against leaks, drips and finish defects to the original homeowner
- 10 year limited warranty when used in a multifamily installation
- 5 year limited warranty when used in a commercial installation

Visit www.moen.com/support for complete details and limitations

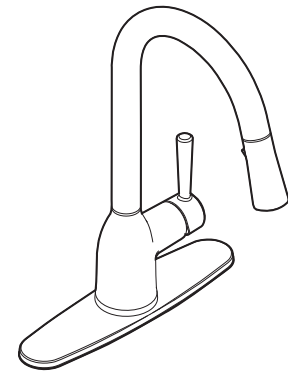

Adler™
Single-Handle High Arc
Pull Down Kitchen Faucet

Model: 87233 series

NOTE: THIS FAUCET IS DESIGNED TO BE INSTALLED THROUGH 1 OR 3 HOLES, 1-1/2" (38mm) MIN. DIA.

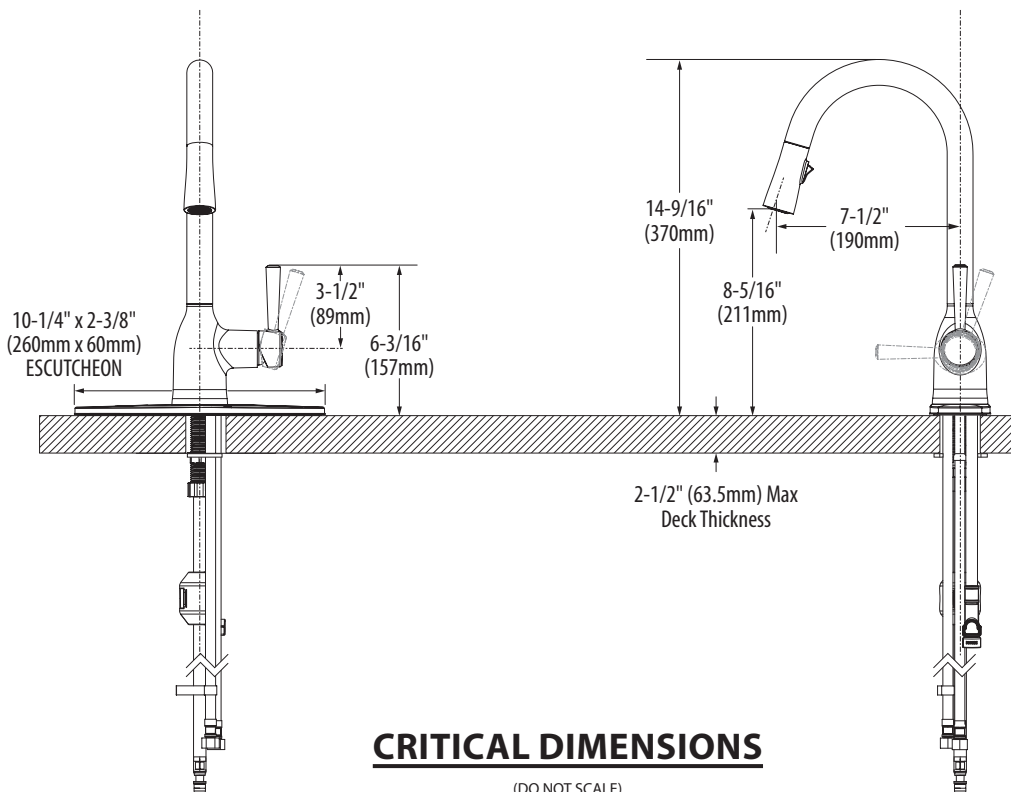

(DO NOT SCALE)

Specification Sheet for Product:

InSinkErator 79850K-ISE

**Power Cord Included Advanced 3/4 HP Continuous Feed Food
Waste Disposal**



ADVANCED SERIES

PRO 750®

Submittal Sheet

This model offers the following features and benefits:

- 3/4 HP long-lasting, Dura-Drive® Induction motor
- Quiet SoundSeal Technology® delivers quiet disposal operation
- Advanced Grind for tough and fibrous food scraps
- 3-Stage MultiGrind® Technology: Finest grind designed to prevent clogs
- EZ Connect Disposal easily connects to a hardwire connection or outlet
- Removable, Dishwasher Safe, Antimicrobial Quiet Collar® Sink Baffle
- Safe for use with properly maintained septic tanks
- Units Available: PRO 750® with EZ Connect Adapter or PRO 750® with EZ Connect Cord

Specifications

Type of Feed	Continuous
On/Off Control	Wall Switch
Motor	Single Phase
HP	3/4
Volts	120
HZ	60
RPM	1725
Amp. (Avg. Load)	9.5
Time Rating	Intermittent
Lubrication	Permanently Lubricated Upper & Lower Bearings
Shipping Weight (Approx.)	18.4, 18.6
Overall Height	12.25
Motor Protection	Automatic Reset
Average Water Usage	Approx. 1 Gallon per Person Per Day
Average Electrical Usage	3-4 KWH per Year
Drain Connection	1-1/2" cushioned slip joint
Dishwasher Drain Connection	Yes

Dimensions

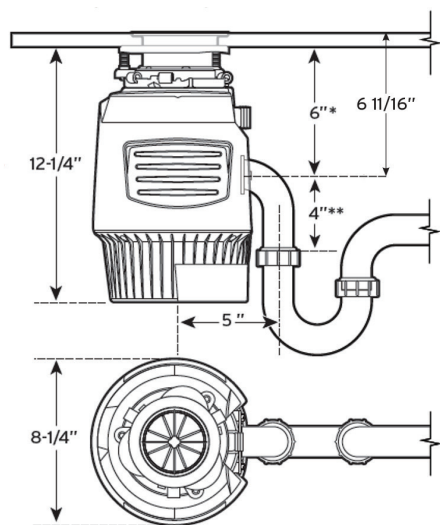

Sample Specification

Food Waste Disposer(s) shall be InSinkErator PRO 750®, continuous feed, with 3/4 HP. motor, stainless steel grinding elements with two stainless steel 360° swivel lugs. Exclusive self-service wrench.

Warranty

10-Year We Come to You® Limited In Home Warranty

* The complete InSinkErator warranty is included in the Care & Use Booklet packed with each unit.



Food waste is roughly 80% water. By using your disposal regularly, you can help divert food waste from landfills and reduce greenhouse gas emissions. Make sustainability a family affair by using your disposal. After all, the smallest changes can make the biggest impact.

Job Specifications



1-800-558-5700
www.insinkerator.com

Specification Sheet for Product:
Moen 3942SRS
Spot Resist Stainless Soap and Lotion Dispenser



Buy it for looks. Buy it for life.®

Specifications

DESCRIPTION

- Available in various finishes identified by suffix

OPERATION

- Press down, pump action

STANDARDS

- Designed and manufactured to comply with the requirements of: CSA B15.1 and ASME A112.18.1 and all requirements referenced therein

WARRANTY

- Lifetime limited warranty against manufacturing and finish defects to the original consumer purchaser
- 5 year warranty if used in commercial installations

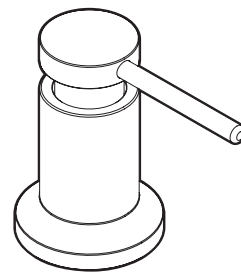

LIQUID DISPENSER

Model: 3942 series

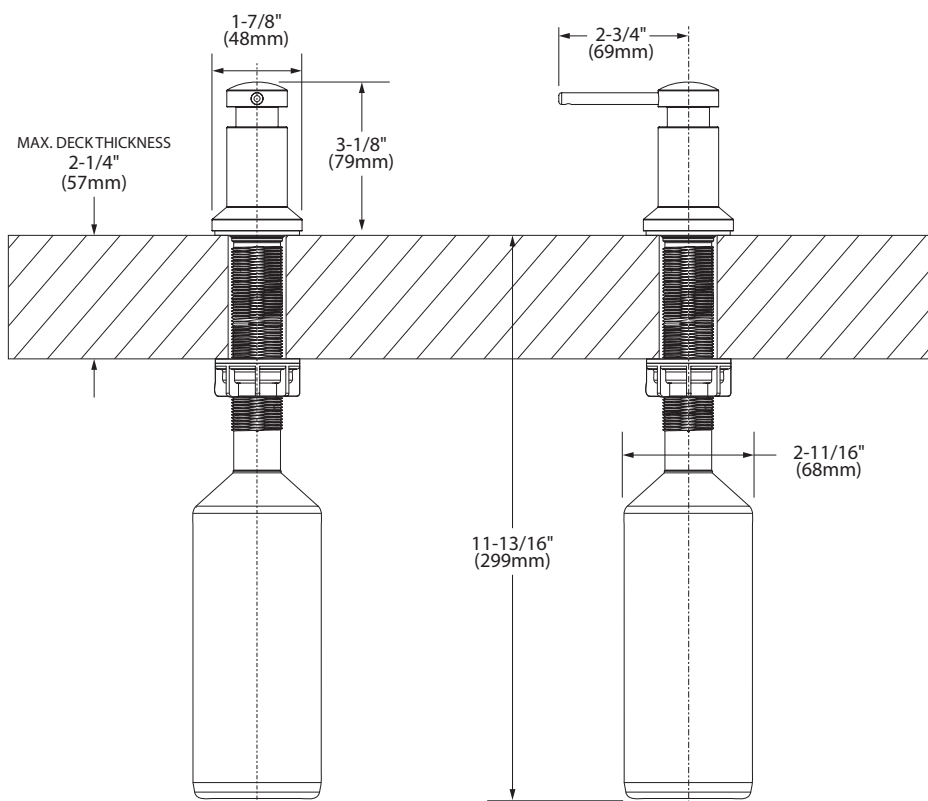

NOTE: DESIGNED TO BE INSTALLED THROUGH 1 HOLE 1-1/8" DIAMETER

CRITICAL DIMENSIONS

(DO NOT SCALE)